

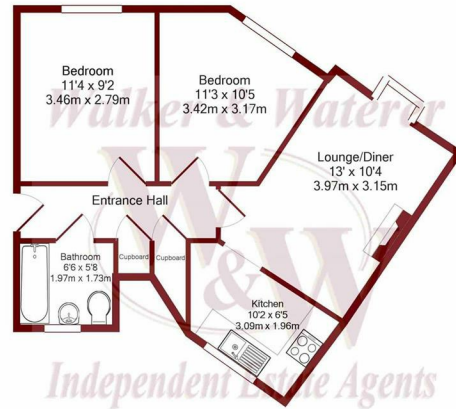

Oak Coppice Road | Whiteley | Fareham | PO15 7GS

£1,000 PCM





Whilst every attempt has been made to ensure the accuracy of the floor plan contained here, measurements of doors, windows, rooms and any other items are approximate and no responsibility is taken for any error, omission, or mis-statement. This plan is for illustrative purposes only and should be used as such by any prospective purchaser. The services, systems and appliances shown have not been tested and no guarantee as to their operability or efficiency can be given.  
Made with Metropix ©2018

Energy Efficiency Rating		Current	Potential
Very energy efficient - lower running costs			
(92 plus)	A		
(81-91)	B		
(69-80)	C		
(55-68)	D		
(39-54)	E		
(21-38)	F		
(1-20)	G		
Not energy efficient - higher running costs			
England & Wales		EU Directive 2002/91/EC	

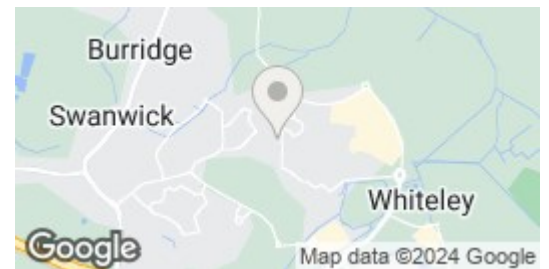

## Description

W&W are delighted to offer for rent this extremely well presented two bedroom ground floor flat. The property enjoys two bedrooms, lounge with open plan access into kitchen, modern family bathroom. The property also benefits from allocated parking spaces and communal gardens. The property will be available from the 5th August. The property will be re-decorated and the bathroom will be replaced.

## Key features

- 2 Bedroom Ground Floor Flat
- Lounge
- Recently Redecorated
- Great Location
- Allocated Parking
- Kitchen
- Refitted Bathroom



H3 Whiteley Shopping Centre  
 Whiteley Way  
 Whiteley  
 Hants  
 PO15 7PD  
 01489 580800  
 pm@walkerwaterer.co.uk  
 www.walkerwaterer.co.uk