

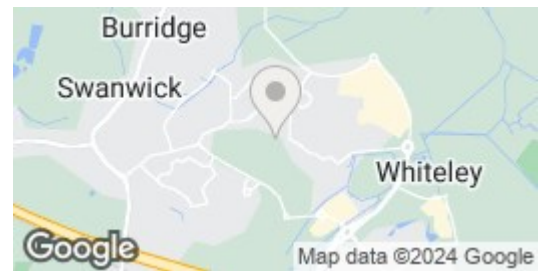

Thyme Avenue | | Whiteley | PO15 7NB

£1,750 PCM

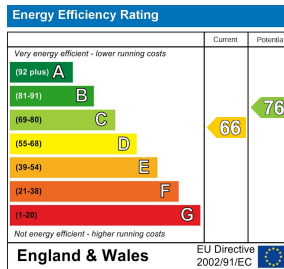

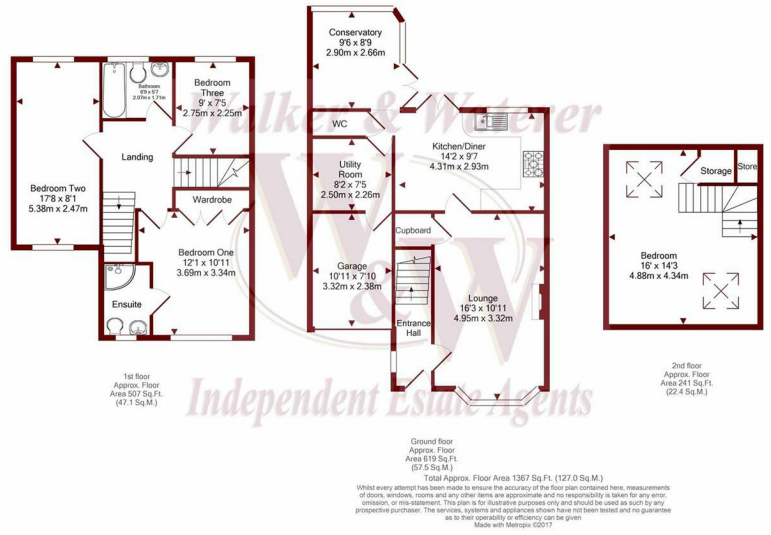

Description

Walker and Waterer are delighted to offer for rental this well presented family home boasting four bedrooms with En-suite to master as well as a family bathroom. The ground floor offers living room alongside impressive conservatory, kitchen/breakfast room & utility room. The home enjoys 'in our opinion' a beautiful quiet private setting with trees to the front & to the rear a tranquil landscaped garden, please call to book your viewing.

Key features

- Well Presented and Improved Family Home
- Lounge With Impressive Bay Window and Contemporary Centre Fireplace
- Modern Re-Fitted Kitchen/Breakfast Room With integrated Appliances
- Part Garage Conversion
- Close Proximity to Whiteley shopping centre



H3 Whiteley Shopping Centre
 Whiteley Way
 Whiteley
 Hants
 PO15 7PD
 01489 580800
 pm@walkerwaterer.co.uk
 www.walkerwaterer.co.uk