



Salt Meat Lane | | Gosport | PO12 1GF

£900 Per Month





Ground Floor
506 sq.ft. (47.0 sq.m.) approx.

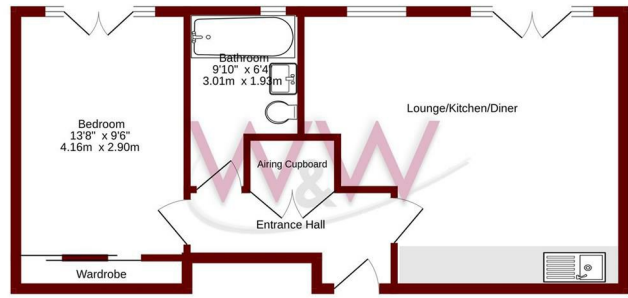

TOTAL FLOOR AREA: 506 sq ft. (47.0 sq.m.) approx.
While every effort has been made to ensure the accuracy of the figures contained here, measurements of doors, windows, rooms and any other items are approximate and no responsibility is taken for any error, omission or mis-statement. This plan is for general guidance only and should be used as such for only prospective purchase. The services, appliances and fixtures shown here have been shown and no guarantee as to their operability or efficiency can be given. Made with MetreGen 02024

Energy Efficiency Rating		Current	Potential
Very energy efficient - lower running costs			
(92 plus)	A		
(81-91)	B		
(69-80)	C		
(55-68)	D		
(39-54)	E		
(21-38)	F		
(1-20)	G		
Not energy efficient - higher running costs			
England & Wales		73	76
EU Directive 2002/91/EC			

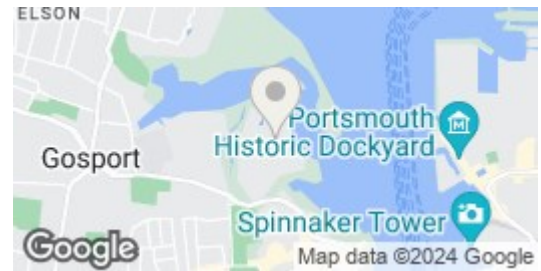

Description

Modern One Bedroom 1st Floor Apartment To Rent ***Open plan Living/Kitchen area Good Size Bedroom***Bathroom***Permit Parking ***Short Walk To Gosport Ferry *** Early Viewing Advised ***Long Term Let Available ***Please call Walker and Waterer Today to arrange your viewing ***

Key features



H3 Whiteley Shopping Centre
Whiteley Way
Whiteley
Hants
PO15 7PD
01489 580800
pm@walkerwaterer.co.uk
www.walkerwaterer.co.uk