



2 Floors



3 Bedrooms



1 En suite

LYTTELTON THREE BEDROOM HOME

A three bedroom detached home with a substantial lounge and an impressive open plan kitchen / dining area with French doors leading to the rear garden. Upstairs boasts three generous bedrooms with the master benefitting from an en suite shower room.

LYTTELTON

THREE BEDROOM HOME

✦ DIMENSIONS

First Floor:

Bedroom 1

2.75m x 3.39m
9'0" x 11'1"

En Suite

Bedroom 2

3.31m x 2.63m
10'10" x 8'7"

Bedroom 3

3.26m x 2.05m
10'8" x 6'9"

Bathroom

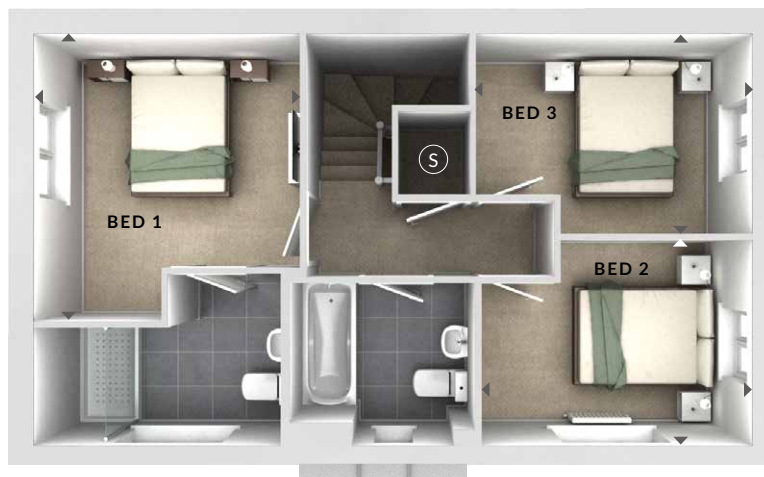

First Floor

Ground Floor:

Lounge

3.26m x 4.75m
10'8" x 15'7"

Kitchen/Dining

2.75m x 4.75m
9'0" x 15'7"

(S) Storage

(C) Cloaks

◄► Measurement Points

△ External Access



Ground Floor