

Description

Porth Eirias, Colwyn Bay is an impressive and iconic development located on the beach-front, right at the heart of the new waterfront improvements at Colwyn Bay commanding breath taking views of the bay and Rhos-on-Sea.

Porth Eirias is currently partly occupied by the award winning Bistro and Cafe developed by Welsh celebrity chef Bryn Williams offering fine dining and Môr a water sports shop and activities provider.

Location

Porth Eirias is located only a short 5 minute walk from Colwyn Bay train station and just 2 minutes from the A55 expressway. Giving easy access to visitors from Holyhead to Chester and beyond.

Opportunity

Conwy County Borough Council is looking to let out a vacant retail and workshop space at Porth Eirias, Colwyn Bay Promenade.

Available space:

- Workshop area is approximately 89.47m².
- Retail area is approximately 101.83m².

Space can be let out individually or collectively

Both available spaces is available from 1st October 2023, subject to landlords consent, planning permissions and building regulations



Viewing

Strictly by appointment

CCBC	Estates & Asset Management
Contact	Lydia Johnson
Phone	01492 574570
Email	Lydia.johnson@conwy.gov.uk

**To Let– Retail & Workshop space Porth Eirias, Colwyn Bay
Promenade, LL29 8HH**



Planning Uses—

Retail space- A1 and D1

Workshop— B1

Catering facilities are not permitted

EPC- B (entire property)

Lease Terms

Full Heads of Terms are available on request.

- Internal Repairing (demise only)
- Rent inclusive of service charge
- Shared staff toilet and kitchen
- NNDR will be separately assessed

Disclaimer

The data provided is for general informational purposes only. All information is provided in good faith, however we make no representation or warranty of any kind, express or implied, regarding the accuracy, adequacy, validity, reliability, availability or completeness of the information.

Under no circumstance shall we have any liability to you for any loss or damage of any kind incurred as a result of the use of, or reliance on, any information provided .

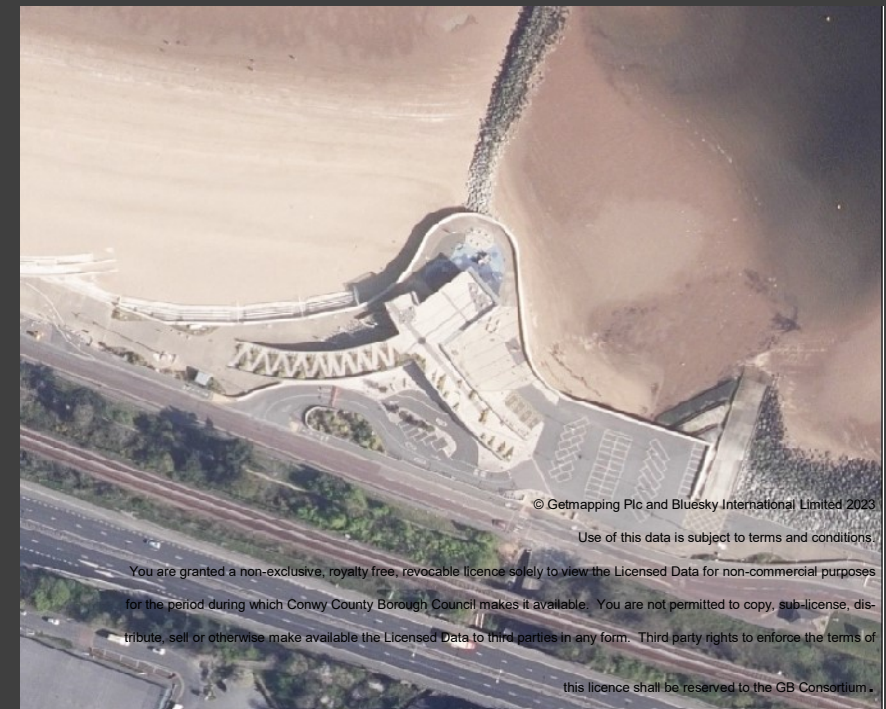
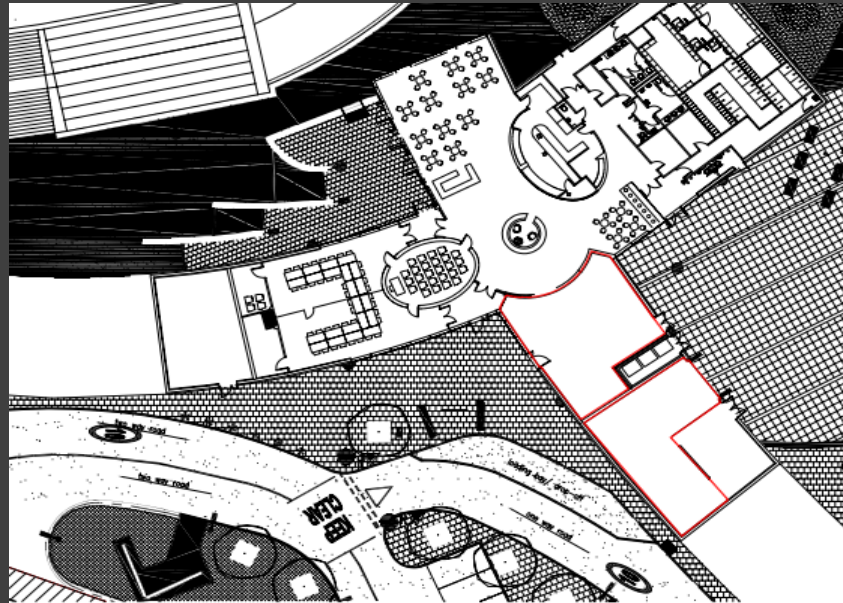

© Getmapping Plc and Bluesky International Limited 2023

Use of this data is subject to terms and conditions.

You are granted a non-exclusive, royalty free, revocable licence solely to view the Licensed Data for non-commercial purposes for the period during which Conwy County Borough Council makes it available. You are not permitted to copy, sub-license, distribute, sell or otherwise make available the Licensed Data to third parties in any form. Third party rights to enforce the terms of

this licence shall be reserved to the GB Consortium.