

Mitre Court  
Taunton  
TA1 3ER











£240,000

- Modern End-Terraced Property
  - Three Bedrooms
  - One Bathroom
  - Lounge/Diner
- Kitchen/Breakfast Room
  - Cloakroom
- Enclosed Rear Garden
  - Parking

NO ONWARD CHAIN. Explore this delightful three-bedroom end-terraced home, nestled just off Victoria Gate on Taunton's eastern edge. Enjoy the nearby Victoria Park (at the end of the road) with its playground, playing fields, dog walking areas, volleyball court, primary school, and GP surgery.

Constructed by Summerfield Homes in 2003 and carefully updated over time, this stunning property is a must-see!

## ACCOMMODATION

This inviting double-glazed and gas centrally heated accommodation features a welcoming entrance hallway, a convenient cloakroom, a kitchen/breakfast room, and a spacious lounge/diner.

Upstairs are three bedrooms alongside a modern bathroom.

Outside, enjoy a shared gated courtyard at the front and a private low-maintenance rear garden, complete with an allocated parking space

## LOCATION

Mitre Court is a desirable neighborhood in Taunton, celebrated for its closeness to the lovely Victoria Park—perfect for relaxed walks and outdoor fun. Just a short distance away is the local primary school, doctors' surgery, and the lively centre of Taunton with an array of shops, eateries, and entertainment options. Easy access to London Paddington from the nearby train station and convenient commuting via the M5 make this location ideal!

## ADDITIONAL INFORMATION

Tenure: Freehold

Estate/Management Charge: No

EPC Rating: C

Council Tax Band: C

## UTILITIES

Water supply: Mains

Sewerage: Mains

Electricity Supply: Mains





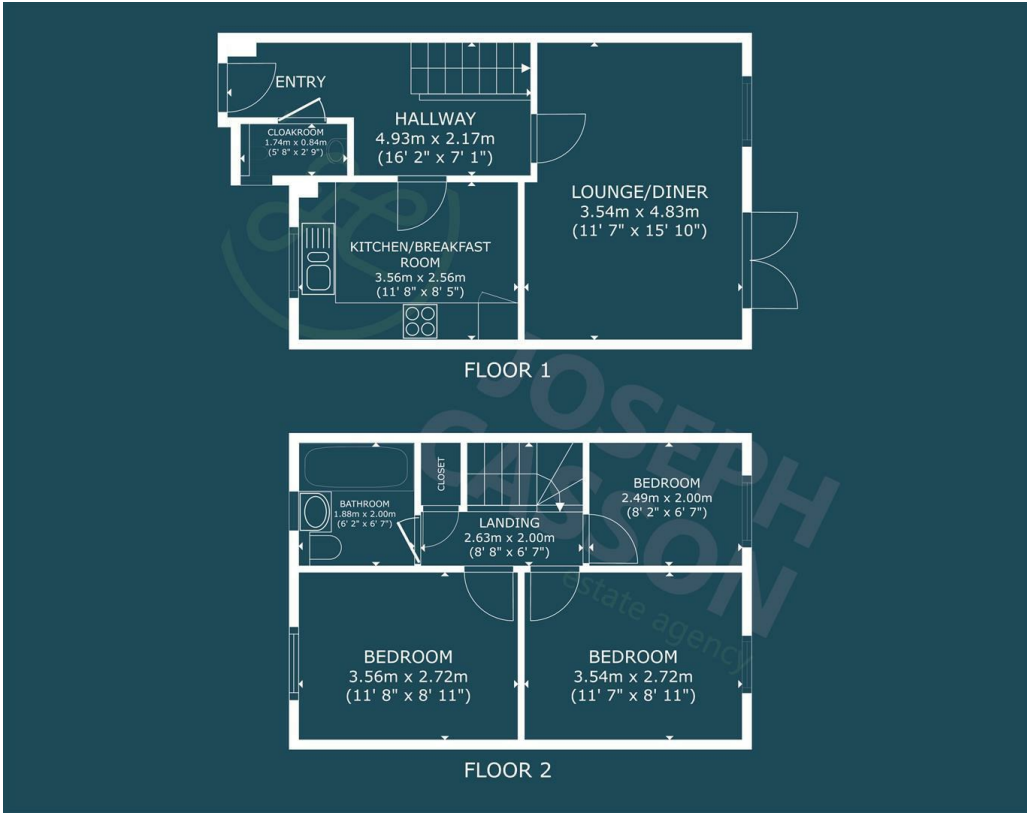

Mains Gas Supply: Yes  
Central Heating: Yes - Gas

FLOODING

No Flooding in the last 5 years. Flood Information: [flood-map-for-planning.service.gov.uk/location](https://flood-map-for-planning.service.gov.uk/location)

BROADBAND & MOBILE COVERAGE

For an indication of specific speeds and supply or coverage in the area, we recommend that potential buyers use the Ofcom checkers below:

[checker.ofcom.org.uk/en-gb/mobile-coverage](https://checker.ofcom.org.uk/en-gb/mobile-coverage)  
[checker.ofcom.org.uk/en-gb/broadband-coverage](https://checker.ofcom.org.uk/en-gb/broadband-coverage)

Council Tax Band

C

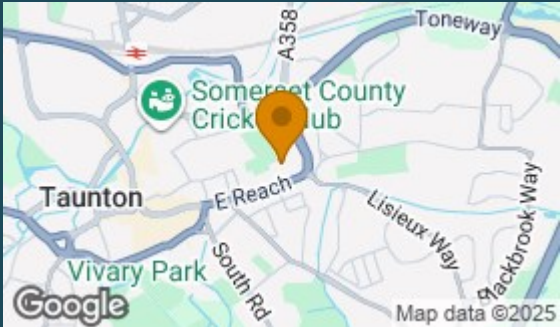
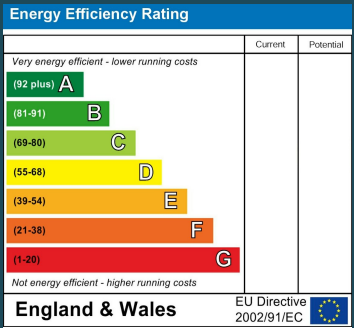

**Agents Note:** Whilst every care has been taken to prepare these particulars, they are for guidance purposes only. All measurements are approximate and are for general guidance purposes only and whilst every care has been taken to ensure their accuracy, they should not be relied upon and potential buyers/tenants are advised to recheck the measurements



Joseph Casson Estate Agency -  
Bridgwater  
1 Friarn Lawn  
Bridgwater  
Somerset  
TA6 3LL



Contact  
01278258005  
[office@josephcasson.co.uk](mailto:office@josephcasson.co.uk)  
[www.josephcasson.co.uk](http://www.josephcasson.co.uk)



**JOSEPH CASSON**  
the estate agency your home deserves