

Kings Drive
Kings Down
Bridgwater
TA6 4TS



JOSEPH CASSON
the estate agency your home deserves





£320,000

- NEW BUILD HOME - Plot 9
 - Four Bedrooms
 - Two Bathrooms
- Open-Plan Kitchen/Dining Room
 - Two Reception Rooms
- Cloakroom & Utility Room
 - Garage & Driveway
 - Enclosed Rear Garden
- 10 Year Builders Warranty
- Completion Due Early 2026!

Explore this stunning NEW double-fronted detached family home. It boasts a contemporary kitchen/diner, two living rooms, and four generously sized bedrooms upstairs with two bathrooms.

Enjoy the private garden, garage, and driveway while being close to shops, restaurants, schools, and transport links!

ACCOMMODATION

This double-glazed and gas centrally heated accommodation briefly comprises: an entrance hallway, lounge, study, kitchen/diner, utility room, and cloakroom to the ground floor, with four bedrooms, (the primary bedroom with en-suite shower room,) and a family bathroom accessed from the first floor landing. Outside, there is an enclosed rear garden, and a garage with parking in front.

LOCATION

This new build home is positioned in Persimmons Kings Copse, within Kings Down, a desirable development just north of Bridgwater, with a range of local facilities including shops, schools, and restaurants nearby. The location offers excellent access to the M5 motorway, A38, and public transport links. Bridgwater's town centre, hospital, and rail station are all within easy reach, and Bristol is approximately 37 miles to the north.

ADDITIONAL INFORMATION

Tenure: Freehold

Estate/Management Charge: To be confirmed.

EPC Rating: B

Council Tax Band: TBC

UTILITIES

Water Supply: Mains

Sewerage: Mains

Electricity Supply: Mains

Gas Supply: Mains

Central Heating: Mains - Gas

FLOODING

No Flooding in the last 5 years. Flood Information: flood-map-for-planning.service.gov.uk/location

BROADBAND & MOBILE COVERAGE

For an indication of specific speeds and supply or coverage in the area, we recommend that potential buyers use the Ofcom checkers below:

checker.ofcom.org.uk/en-gb/mobile-coverage

checker.ofcom.org.uk/en-gb/broadband-coverage

IMAGES

The images featured in this advertisement are intended to give you a sense of the space and style of the home.

Please note that actual finishes and layouts may differ from what is shown.

Unfortunately, there isn't a showhome for this property type. However, we'd love to chat about how you can reserve your new home! Reach out to us today and let's make your dream come true!



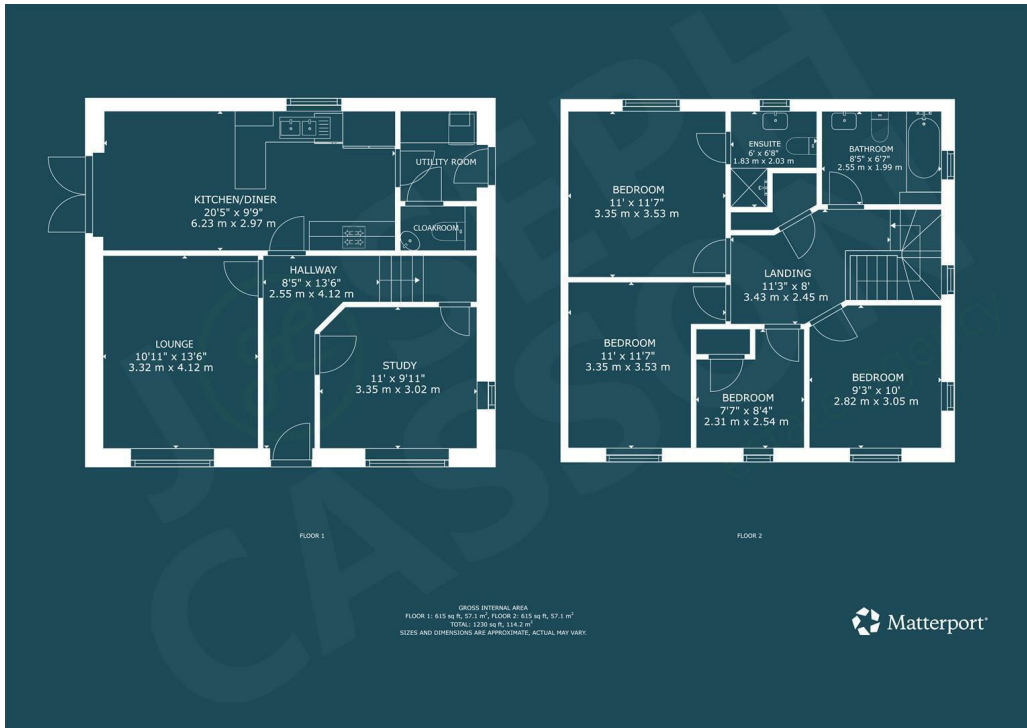

Council Tax Band

B

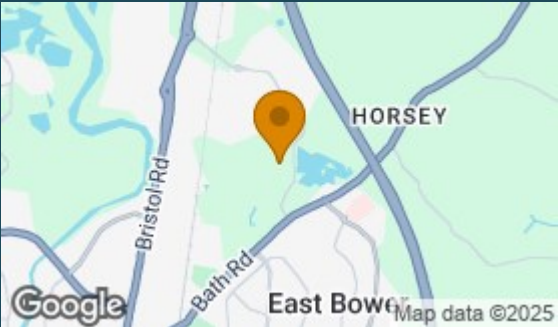
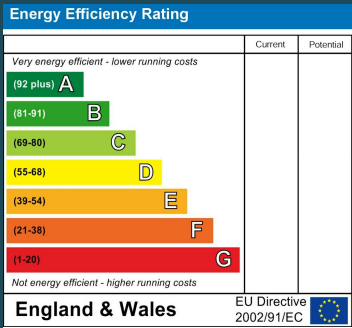

Agents Note: Whilst every care has been taken to prepare these particulars, they are for guidance purposes only. All measurements are approximate and are for general guidance purposes only and whilst every care has been taken to ensure their accuracy, they should not be relied upon and potential buyers/tenants are advised to recheck the measurements



Joseph Casson Estate Agency -
Bridgwater
1 Friarn Lawn
Bridgwater
Somerset
TA6 3LL

Contact
01278258005
office@josephcasson.co.uk
www.josephcasson.co.uk



JOSEPH CASSON

the estate agency your home deserves