

Theillay Close
Nether Stowey
Bridgwater
TA5 1JY



JOSEPH CASSON
the estate agency your home deserves





£210,000

- Modern End Terraced Property
 - Two Bedrooms
 - Bathroom
 - Lounge
- Open-Plan Kitchen/Diner
- Rear Aspect Countryside Views
- Gas Central Heating & Double Glazing
 - Allocated Parking
 - EPC RATING: C
 - Council Tax Band: B

Nestled on the outskirts of the quaint village of Nether Stowey, right at the base of the picturesque Quantock Hills, you'll find this charming two-bedroom end-terraced home. Tucked away in a peaceful cul-de-sac, this property boasts stunning countryside views from the rear aspect.

ACCOMMODATION

This well-presented property briefly comprises: an entrance hallway, cloakroom, and open-plan kitchen/diner to the ground floor, with the living room, two bedrooms, and a bathroom on the first floor. Outside, there is one allocated parking space.

LOCATION

Located on the Northern outskirts of Nether Stowey, Hartley Meadow offers the ideal balance between modern convenience and country living. The historic village of Nether Stowey has many facilities including a library, restaurant, butchers and three pubs.

The Quantock Hills offer a wide range woodland and moorland walks. Slightly further away, the bustling market town of Bridgwater offers a wider range of amenities and has excellent transport links to the M5 motorway and mainline rail link.



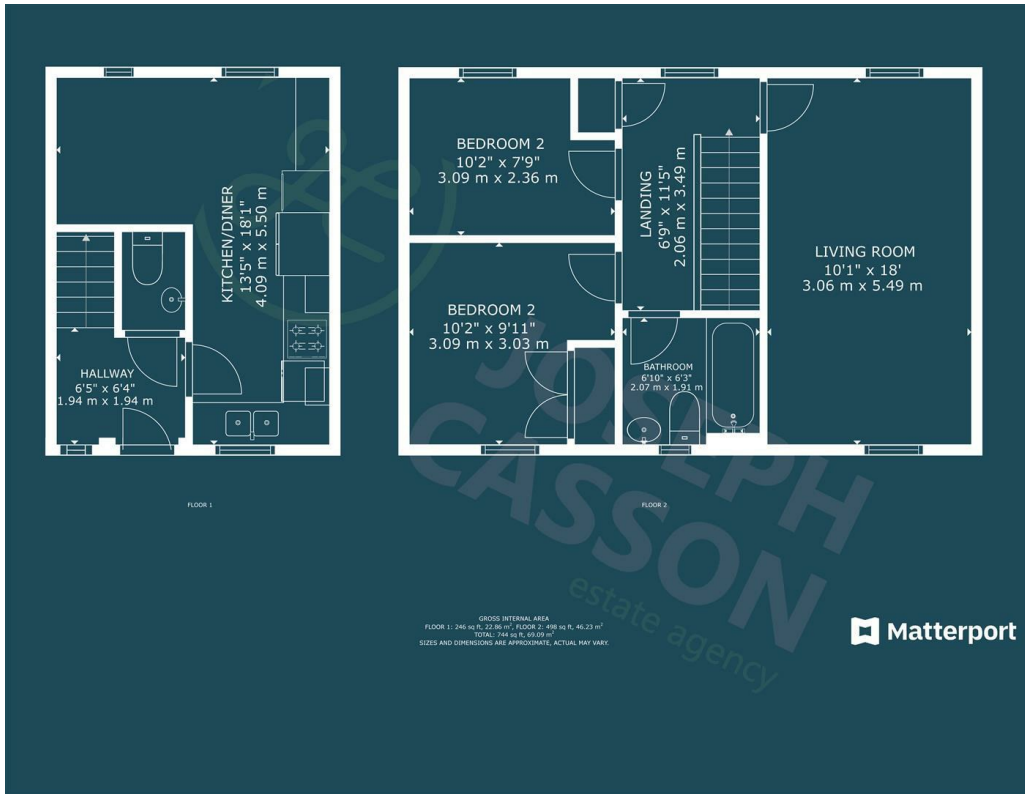

Council Tax Band

B

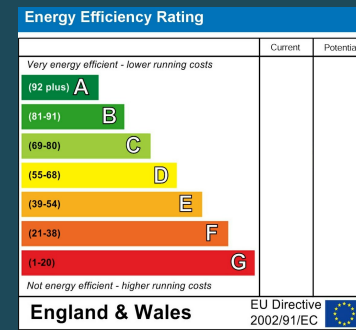

Agents Note: Whilst every care has been taken to prepare these particulars, they are for guidance purposes only. All measurements are approximate and are for general guidance purposes only and whilst every care has been taken to ensure their accuracy, they should not be relied upon and potential buyers/tenants are advised to recheck the measurements



Joseph Casson Estate Agency -
Bridgwater
1 Friarn Lawn
Bridgwater
Somerset
TA6 3LL



Contact
01278258005
office@josephcasson.co.uk
www.josephcasson.co.uk



JOSEPH CASSON

the estate agency your home deserves