

Southfields Road, Littlehampton, BN17 6PB

Freehold

Four-Bedrooms • End of Terrace House • CHAIN FREE! • South-Facing Garden Plus Courtyard Side Garden • Garage & Driveway with Additional Parking Spaces • Ground Floor Bedroom with En-Suite • Popular Beaumont Park Area • Close Proximity to Rustington Village • Approx. 1216 sq. ft (113 sq. m)

Cooper Adams

This four-bedroom family home is situated within close proximity to local schools and Southfields Park. Whether you and your family are looking to up-size or to take your first steps on the property ladder, then this home may just be the one for you. Benefiting from a south-facing garden with additional courtyard garden to the side, a garage and driveway, plus a ground-floor bedroom with en-suite - this home really is perfect for the whole family. Give us a call to arrange your viewing!

This property is "Legally Prepared." Cooper Adams has gathered key documents, including the title, plans, property forms, warranties, and EPC. Buyers must request these before offering.

The seller requires a 'Reservation Agreement' to protect serious buyers as they proceed to exchange of contracts.



Littlehampton, a vibrant seaside town at the River Arun's mouth, offers great shopping, entertainment, and day-to-day amenities. With two award-winning beaches, scenic river views, and captivating architecture like the Stage by the Sea, it's a popular destination for all. Leisure options include golf, cycling, and the Littlehampton WAVE Swimming and Sports Centre for indoor fun.



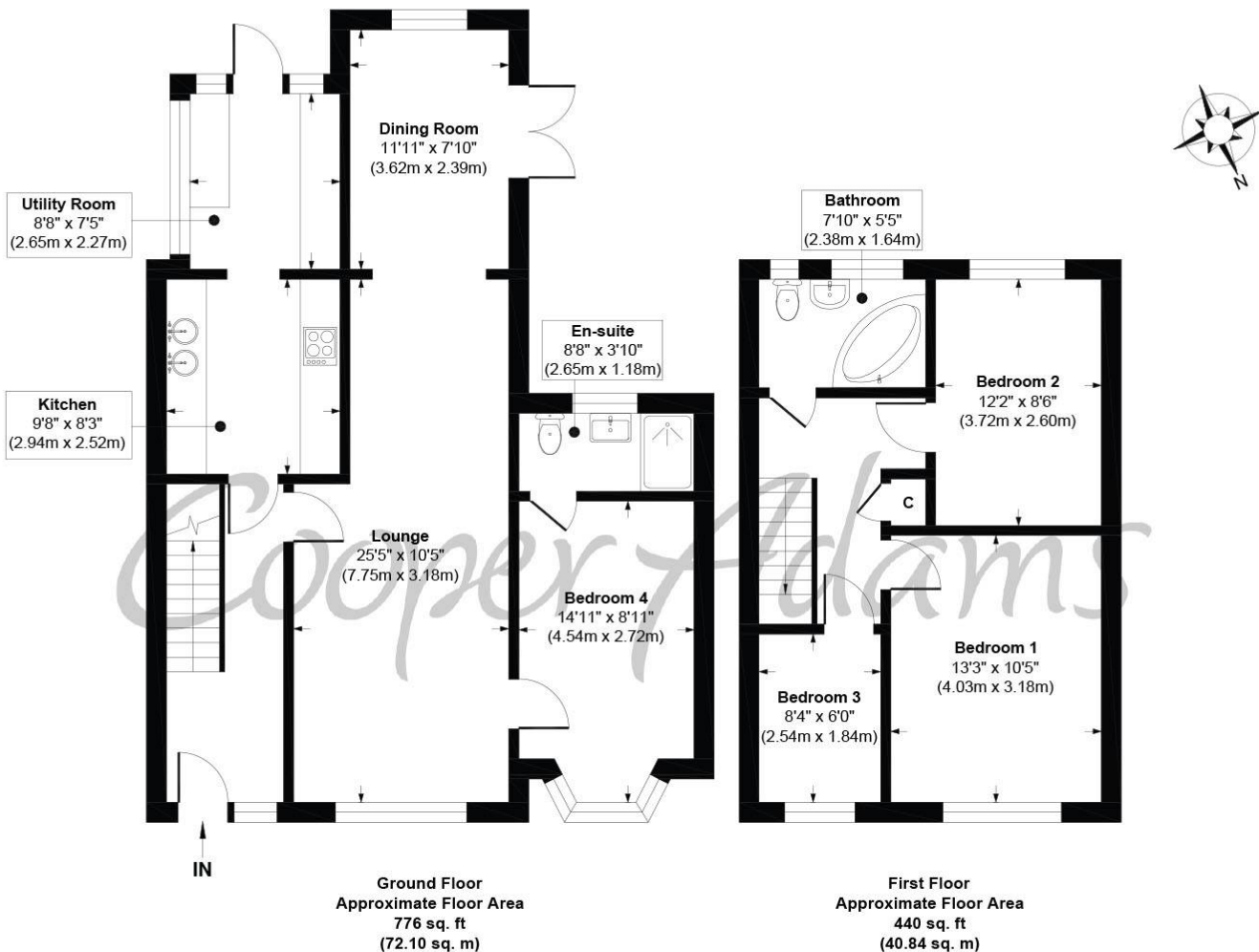

Southfields Road, Littlehampton
Approx. Gross Internal Floor Area 1216 sq. ft / 112.94 sq. m

Illustration for identification purposes only, measurements are approximate, not to scale

Copyright © Cooper Adams

Council Tax band: D, EPC Energy Efficiency Rating: C, EPC Environmental Impact Rating: C

This material is protected by laws of copyright which is owned by Cooper Adams. Whilst every attempt has been made to ensure the accuracy of these details and floor plan contained herein, they do not constitute any offer or contract or part thereof. All measurements are always maximum measurements into bay windows, alcoves and for L shaped rooms. No guarantee is given on total square footage taken from the floor plan. The details, pictures, maps and floor plans are for illustration purposes only and not to scale. Any appliances and/or services have not been tested. Cooper Adams is a trading name of Cooper Adams Estates Limited registered at Bishopstone, Registered in England and Wales. Our registered number is 07127482. Our VAT Number is 962847172.

Lettings | Sales | Free valuations | Land & New Homes | Mortgages

VIEWING STRICTLY BY APPOINTMENT

FOR MORE PHOTOS AND TO BOOK A VIEWING VISIT OUR WEBSITE Tel: 01903 791 792 www.cooper-adams.com