

 **HOUSE
CLICKERS**
YOUR LOCAL PROPERTY EXPERTS



Fauconberg Way, Yarm, TS15 9QN
£157,500

NO CHAIN. Fabulous Extended Detached Two Double Bedroom Home Located in the popular Layfield Estate within easy access to Layfield Primary, Conyers Secondary School and Yarm Train station. Externally the property has a garden to the front and is approached by a drive that runs to the side and leads to the Single garage and a paved garden to the rear. Internally there is a spacious lounge, Large kitchen with leads to the conservatory. To the First Floor there are Two Double Bedrooms and a Bathroom. The property also has Upvc double glazing and a gas central heating system. This property is guaranteed to appeal to a large audience so contact us to avoid disappointment.

Lounge

14' 7" x 13' 2" (4.44m x 4.01m) reduces to 11' x 13'2"

Kitchen

13' 10" x 7' 10" (4.21m x 2.39m)

Conservatory

11' 3" x 8' 1" (3.43m x 2.46m)

Bedroom 1

10' 8" x 10' 10" (3.25m x 3.30m)

Bedroom 2

10' 6" x 7' 11" (3.20m x 2.41m)

Bathroom

6' 6" x 5' 6" (1.98m x 1.68m)

Single Garage





GROUND FLOOR

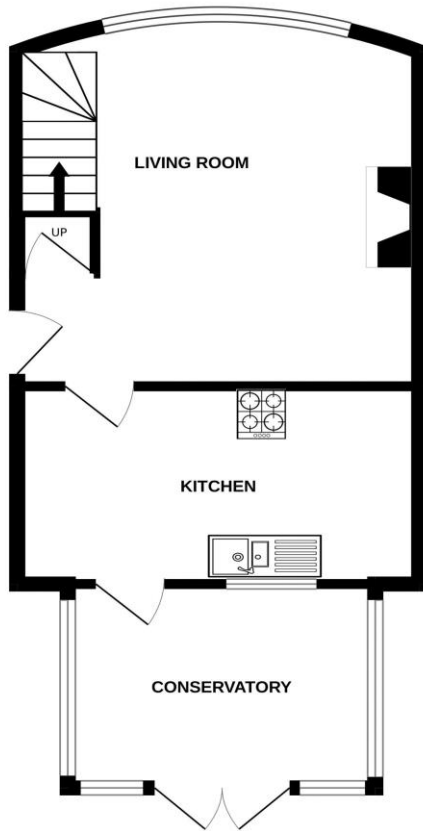

1ST FLOOR

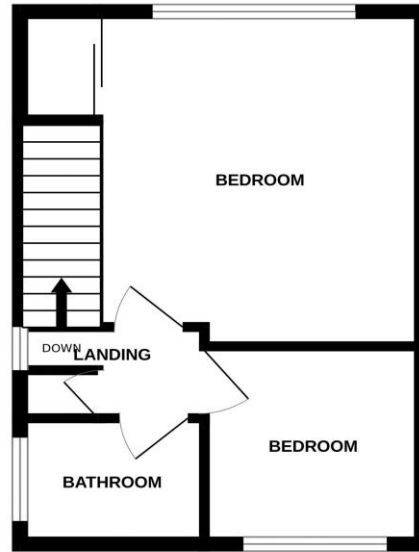

Whilst every attempt has been made to ensure the accuracy of the floorplan contained here, measurements of doors, windows, rooms and any other items are approximate and no responsibility is taken for any error, omission or mis-statement. This plan is for illustrative purposes only and should be used as such by any prospective purchaser. The services, systems and appliances shown have not been tested and no guarantee as to their operability or efficiency can be given.
Made with Metropix ©2024

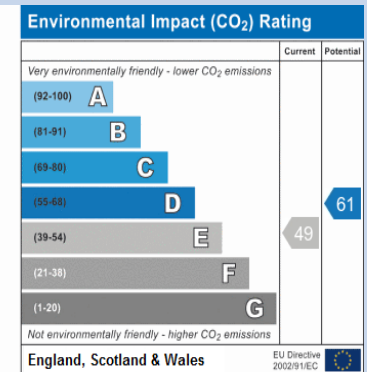
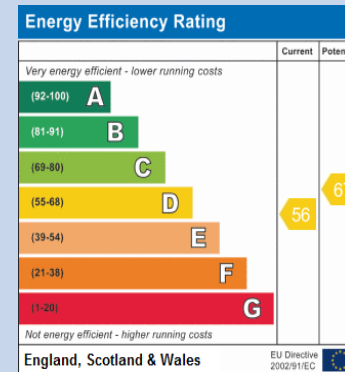

House Clickers Ltd
Tel: 01642789649 , enquiries@houseclickers.co.uk
www.houseclickers.co.uk