

 **HOUSE
CLICKERS**
YOUR LOCAL PROPERTY EXPERTS



Atlas Wynd, Yarm, TS15 9AD
£159,500

Quaint 2 Bedroom Period Cottage Located on Atlas Wynd, just a few steps from the many attractions, restaurants, bars and cafes of the popular Yarm high street, yet close to the riverside in a tranquil setting. This warm and welcoming home is simply delightful, with many period features and a contemporary twist. The property consists of a good-sized lounge/ open plan stylish kitchen diner. To the first floor is two double bedrooms and a beautiful bathroom. Early viewings advised. Ideal for holiday lets or rental investment

Lounge/Diner/Kitchen

21' 1" x 14' 4" (6.42m x 4.37m) reducing to 11'4

Bedroom 1

11' 4" x 10' 3" (3.45m x 3.12m)

Bedroom 2

10' 1" x 8' 1" (3.07m x 2.46m)

Bathroom

6' 10" x 5' 5" (2.08m x 1.65m)





GROUND FLOOR

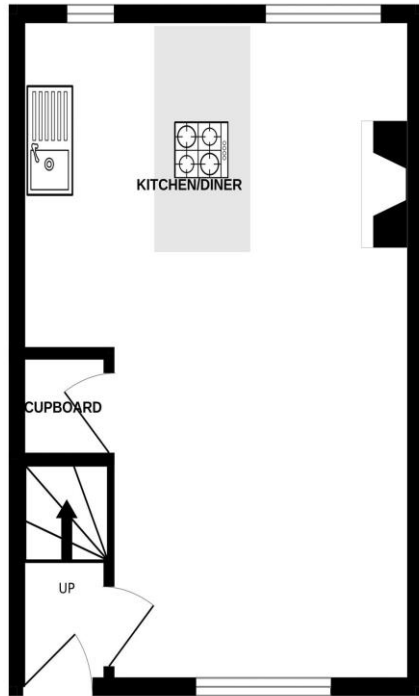

1ST FLOOR

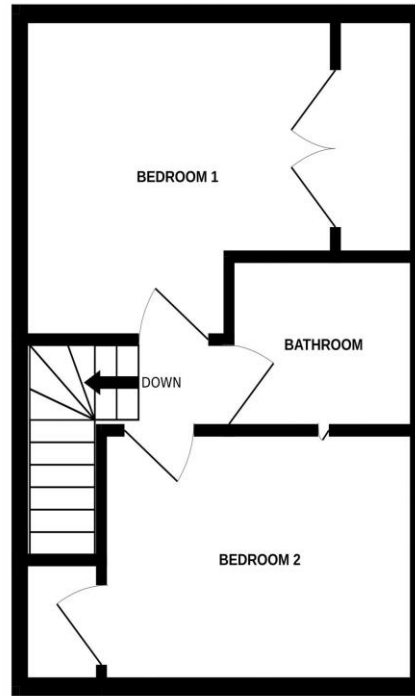

Whilst every attempt has been made to ensure the accuracy of the floorplan contained here, measurements of doors, windows, rooms and any other items are approximate and no responsibility is taken for any error, omission or mis-statement. This plan is for illustrative purposes only and should be used as such by any prospective purchaser. The services, systems and appliances shown have not been tested and no guarantee as to their operability or efficiency can be given.
Made with Metropix ©2024

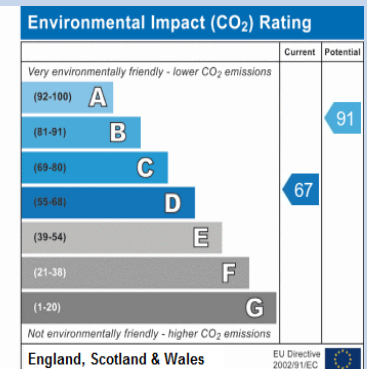
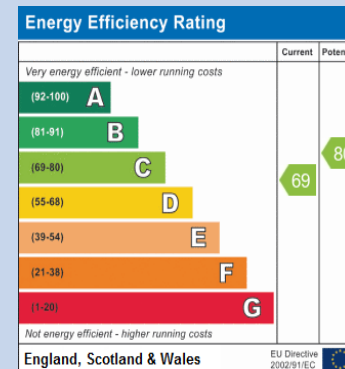

House Clickers Ltd
Tel: 01642789649 , enquiries@houseclickers.co.uk
www.houseclickers.co.uk