



Carew Close, Yarm, TS15 9TJ
£195,000

Delightful Detached 2 Bedroom Bungalow located on a large plot on a quiet cul-de-sac in the popular Layfield Estate walking distance to Yarm train station and local bus routes and excellent access for those needing the A19. The property is in need of some cosmetic updating and has fabulous potential to make someone a wonderful home with plenty of space to extend if required planning dependant. On entering the property there is an entrance hall, spacious lounge with gas fire, good size kitchen with light pine units providing ample storage. There are 2 Generous double bedrooms both overlooking the rear garden and a family bathroom. Externally there is a concrete driveway leading to the lean-to car port. Lawned Front garden and Large rear garden with paved area and lawn. Boiler replaced in Nov 2023 and 7 years warranty.

Kitchen

9' 3" x 9' 11" (2.82m x 3.02m)

Lounge

18' 9" x 13' 2" (5.71m x 4.01m)

Bedroom 1

11' 5" x 11' 5" (3.48m x 3.48m)

Bedroom 2

11' 0" x 9' 10" (3.35m x 2.99m)

Bathroom

7' 7" x 5' 7" (2.31m x 1.70m)





GROUND FLOOR

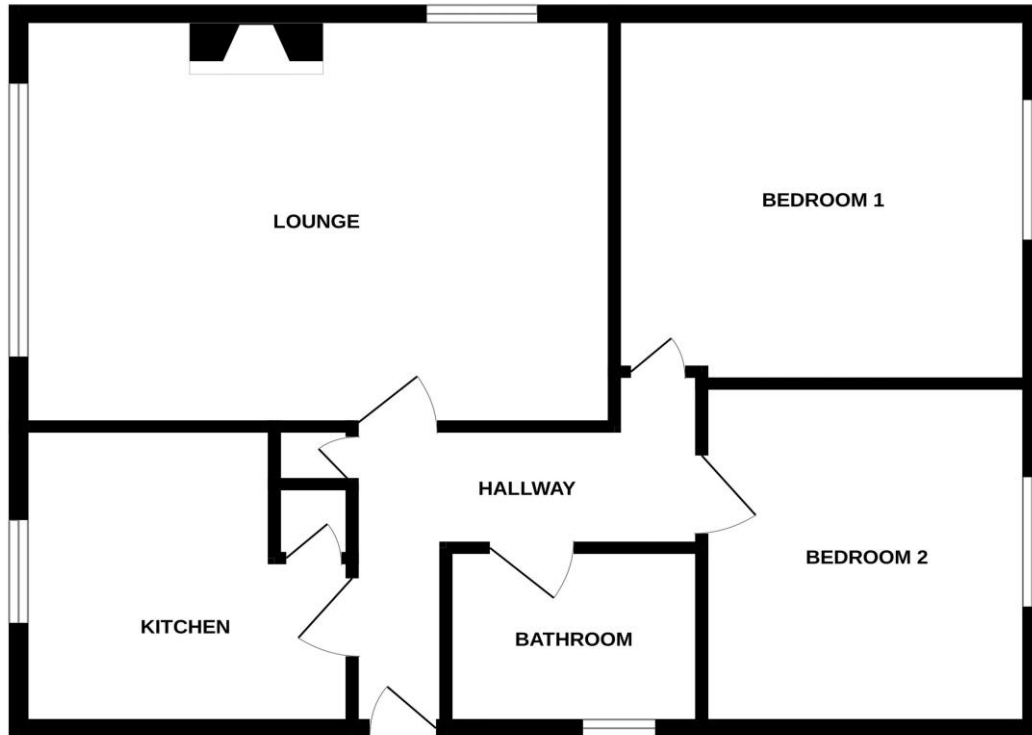

Whilst every attempt has been made to ensure the accuracy of the floorplan contained here, measurements of doors, windows, rooms and any other items are approximate and no responsibility is taken for any error, omission or mis-statement. This plan is for illustrative purposes only and should be used as such by any prospective purchaser. The services, systems and appliances shown have not been tested and no guarantee as to their operability or efficiency can be given.
Made with Metropix ©2024

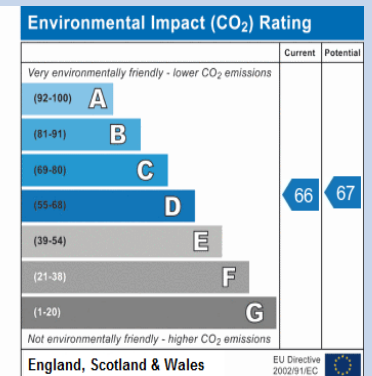
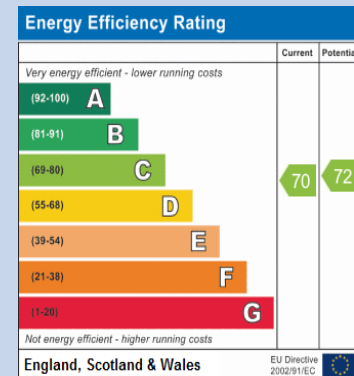

House Clickers Ltd
Tel: 01642789649 , enquiries@houseclickers.co.uk
www.houseclickers.co.uk