



lettingInternational



39b Walton Road

, London, E13 9BW

Offers Around £250,000



Floor Plan

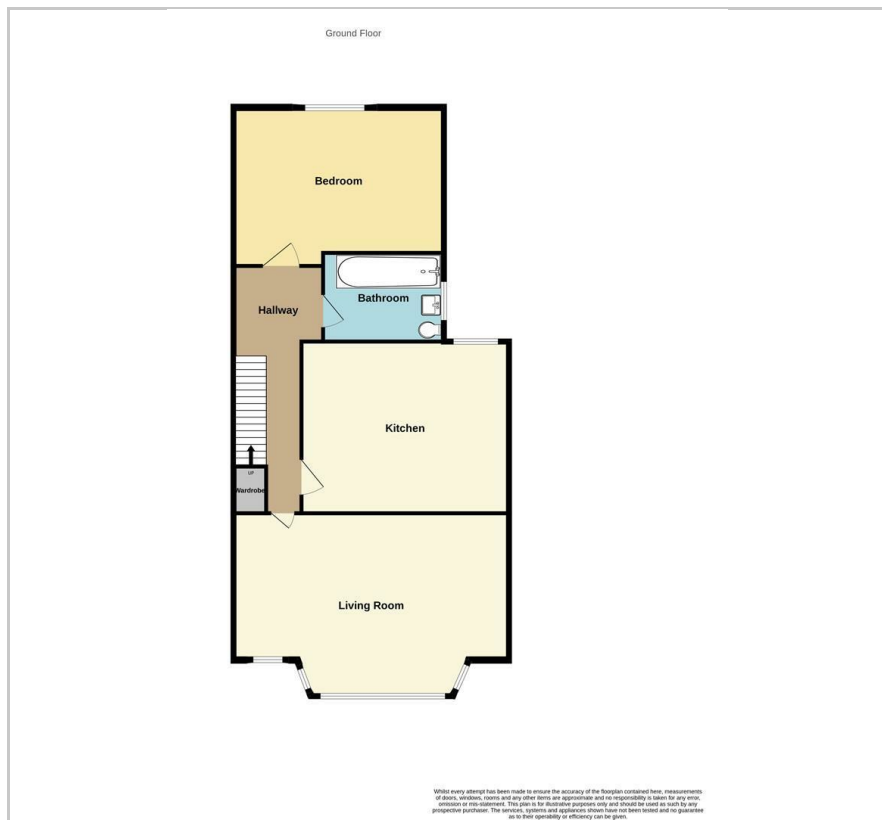

Area Map

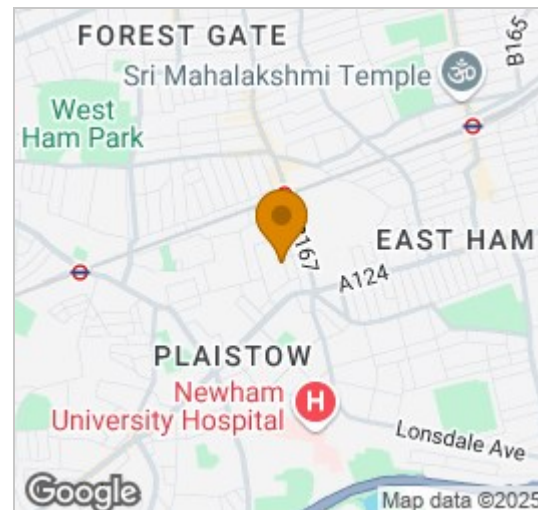

Energy Efficiency Graph

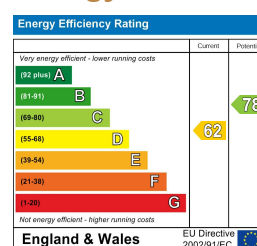

Viewing

Please contact our Letting International LTD Office on 02085549999 if you wish to arrange a viewing appointment for this property or require further information.

- Excellent Transport Links
- Close to Shops
- Fitted Kitchen
- Spacious Reception
- Double Glazing



Positioned on a residential turning in Upton Park is this well-presented first-floor flat.

This period conversion boasts good accommodation throughout and is tastefully presented. Located well for all local amenities with cafes, eateries, retail and grocery shops in close proximity. The property also provides easy access to various transport links with different bus ranks available on Green Street taking you towards Stratford and Canning Town. Minutes way from Upton Park tube station

Tenure - Leasehold -

Local Authority - London Borough Of Newham -

81 Years Lease -

EPC - D (62)



These particulars, whilst believed to be accurate are set out as a general outline only for guidance and do not constitute any part of an offer or contract. Intending purchasers should not rely on them as statements of representation of fact, but must satisfy themselves by inspection or otherwise as to their accuracy. No person in this firm's employment has the authority to make or give any representation or warranty in respect of the property.

332 - 336 Perth Road, Ilford, Essex, IG2 6FF

Tel: 02085549999 Email: sales@lintgroup.com www.lettinginternational.com