

# Horton & Senate



1238 Yardley Wood Road, Shirley, Solihull, B90 1JX

£325,000

- Semi Detached House
- Two Receptions
- Sold With No Upward Chain
- Three Double Bedrooms
- Large Driveway
- Generous Rear Garden



# 1238 Yardley Wood Road, Solihull B90 1JX

This three-bedroom house in Shirley presents a wonderful opportunity for those seeking a comfortable and well-located residence. Do not miss the chance to make this lovely property your own.

3

1

2

Council Tax Band: C











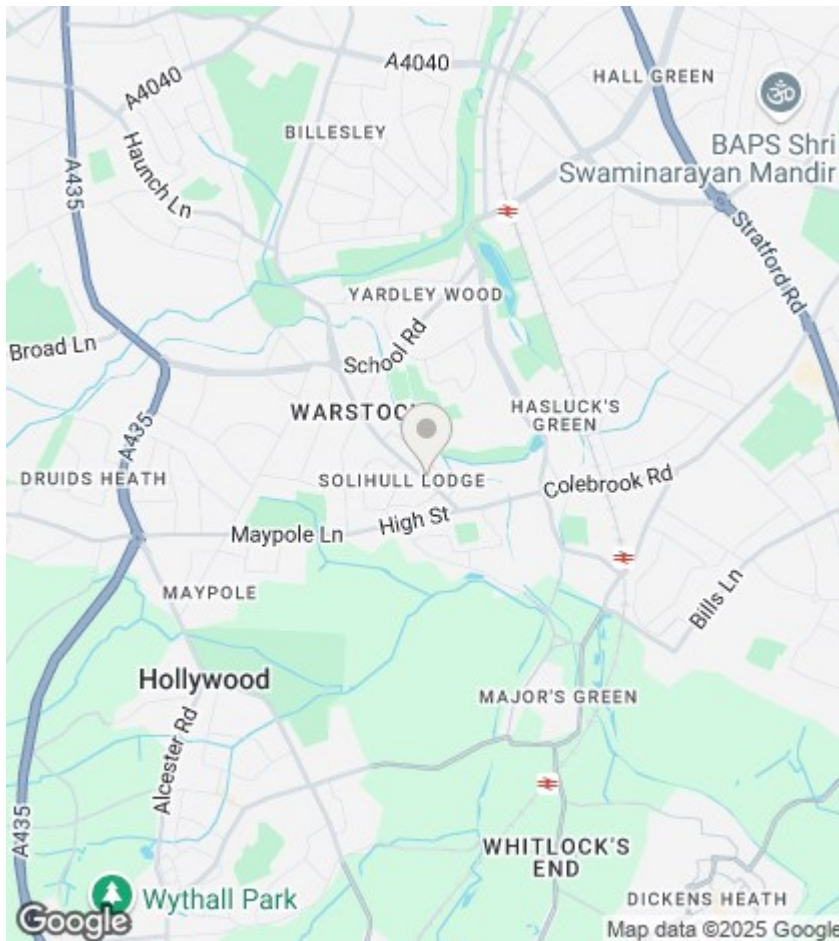

## Directions

## Viewings

Viewings by arrangement only. Call 0121 663 0099 to make an appointment.

## EPC Rating:

Energy Efficiency Rating		
	Current	Potential
Very energy efficient - lower running costs		
(92 plus) <b>A</b>		
(81-91) <b>B</b>		
(69-80) <b>C</b>		
(55-68) <b>D</b>		
(39-54) <b>E</b>		
(21-38) <b>F</b>		
(1-20) <b>G</b>		
Not energy efficient - higher running costs		
England & Wales	EU Directive 2002/91/EC	

## Ground Floor

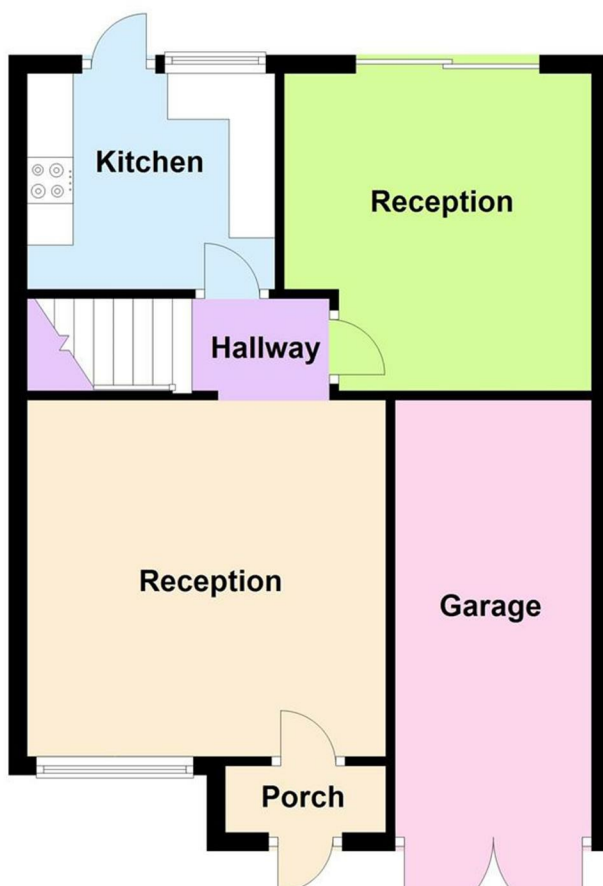

## First Floor

