



HELENA ROAD

Located in the heart of central Southsea

NEXA PROPERTIES

15 Hampshire Terrace
Portsmouth, Hampshire
PO1 2QF

T: 02392 295046

E: hello@nexaproperties.com

W: www.nexaproperties.com

KEY HIGHLIGHTS

- FIVE BEDROOM LINK-DETACHED HOME
- SECURITY GATED ENTRANCE
- STUNNING CINEMA ROOM
- MODERN INTERIOR
- IMPRESSIVE AND SUBSTANTIAL RESIDENCE
- VICTORIAN FEATURES
- 3625 SQ FT OF LIVING SPACE
- GENEROUS SLATE DRIVEWAY
- POPULAR LOCATION
- EXCELLENT SCHOOL CATCHMENT

'Elysia' is an impressive and striking, five bedroom link detached house located close to the Southsea Victorian Promenade.

This substantial residence offers generous proportions throughout and is situated in a very desirable location just a short walk from the popular Canoe Lake and Southsea Seafront.







Downstairs has been fully renovated with a stunning basement level boasting a spectacular cinema room, utility space and separate reception perfectly set up for a gym or laundry room. Although the property has been fully renovated with bespoke features throughout the current residents have kept the original Victorian features and when you combine the two this makes for the perfect family home.



THE PROPERTY







As you lead up through this quintessential home, all bedrooms are vast in size and further bonuses include the four piece bathroom suite and en-suite bathroom with his and hers separate showers.



THE PROPERTY







THE PROPERTY







This extensive and impressive accommodation welcomes you with a security gated entrance and spacious driveway and internally provides 3625 sq ft of living space.

Arranged over four floors, it comprises on the ground floor of entrance hallway leading to two separate reception areas, w.c. and kitchen/diner with bi-folding doors leading to the low

THE PROPERTY



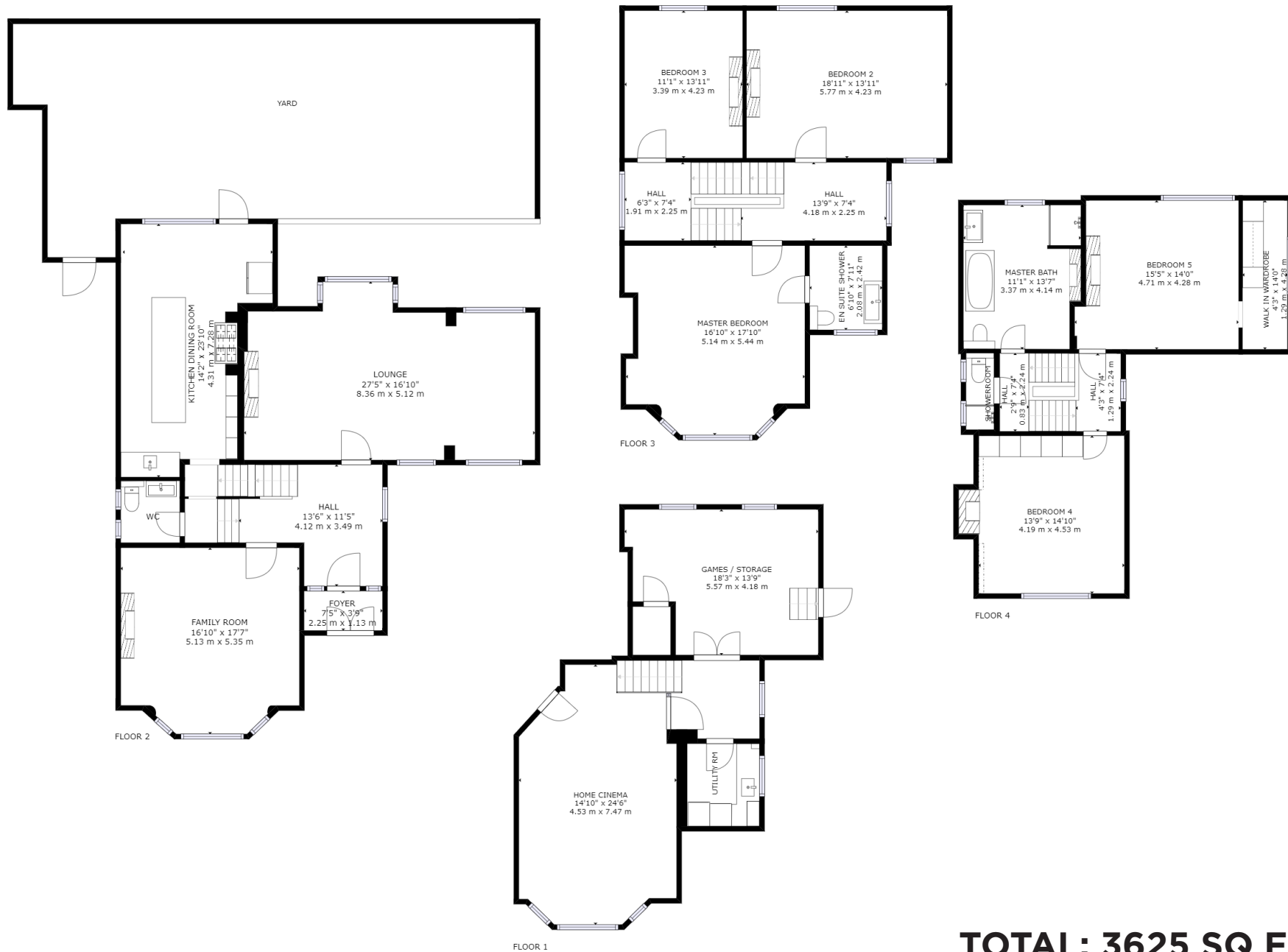

TOTAL: 3625 SQ FT



FLOORPLAN

WHY CHOOSE NEXA?

We are a different type of estate agency. We provide you with a local industry professional to act as your dedicated account manager who will be your single point of contact. This means you only ever deal with one agent and you receive a seamless and transparent solution.

Our unique business model rewards our account managers on a highly competitive **results-based structure** that enables us to source the best people for the job and create a **better experience** for you, and a more **rewarding and motivating experience** for our staff.

Your account manager is **personally assigned** to you and will provide a **personal service** from start to finish through the entire journey, **available any time of day**, enabling us to create a **high-performance culture** and a **customer-centric** estate agency



NEED A MORTGAGE?

We work closely with a small, handpicked selection of professional mortgage brokers who can help you find the right mortgage. There are some great deals out there and a good mortgage broker can help you find them whilst also revealing the loopholes and limitations that apply. This will help to ensure that you find the best lender and agreement for your particular circumstances and plans. Talk to your Nexa Agent and they will arrange your meeting with one of our excellent mortgage brokers.

NEED A SOLICITOR?

Having worked in property for many years here in Portsmouth, we have been fortunate enough to build relationships with a number of excellent legal firms and solicitors that specialize in property transactions and contracts. We now work closely with these firms to ensure that our clients have access to the best legal support available in the City. Simply talk to your Nexa agent who will help you find the best solicitor for your needs.





NEXA PROPERTIES

15 Hampshire Terrace
Portsmouth, Hampshire
PO1 2QF

T: 02392 295046

E: hello@nexaproperties.com

W: www.nexaproperties.com

