

TO LET

32 The Fairway, Aldwick Bay Estate, Aldwick, Bognor Regis, PO21 4HD
£1,350,000

- Over 3000 sq ft Of Accommodation
- Substantial Five Double Bedroom House
- Aldwick Bay Estate
- Southerly Facing Rear Garden
- Hot Tub & Entertainment Decked Area
- Double Garage & Dual Entrance Driveway
- Spacious Kitchen & Utility Room
- Master Bedroom With Balcony
- Sea Views
- Access to Aldwick Bay Private Beach

THE PROPERTY

Nestled just a stone's throw from the secluded Aldwick Bay Beach within the peaceful and coveted Aldwick Bay Estate lies a substantial five-bedroom detached family home and offered with no forward chain.

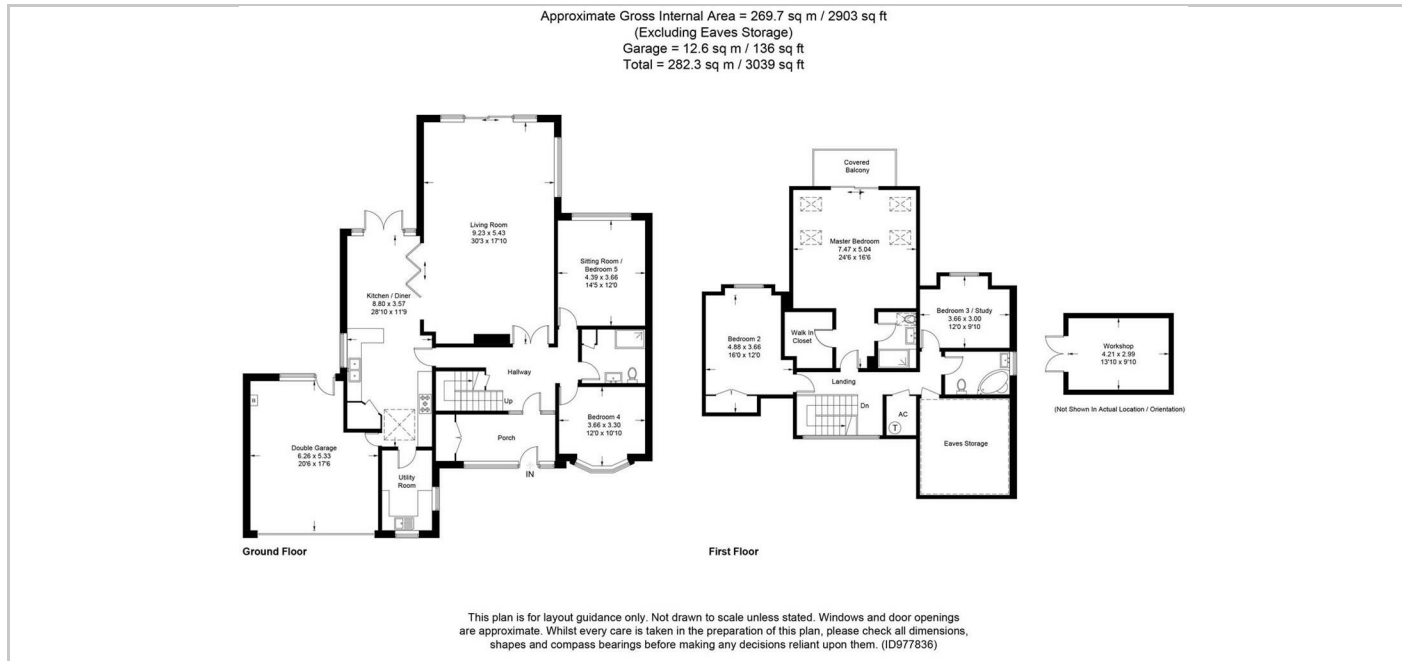

SITUATION

Directions