



2 Floors



4 Bedrooms



Utility



1 En suite

## WOLLATON FOUR BEDROOM HOME

A four bedroom detached home with spacious lounge and fantastic open plan kitchen / dining and family area featuring a bay window and French doors leading to the rear garden. Upstairs, is the family bathroom and four bedrooms, the master bedroom benefitting from fitted wardrobes and en suite facilities.

# WOLLATON FOUR BEDROOM HOME

## ⬢ DIMENSIONS

### First Floor:

#### Bedroom 1

2.88m x 3.68m  
9'6" x 12'1"

#### En Suite

#### Bedroom 2

3.60m x 2.47m  
11'10" x 8'1"

#### Bedroom 3

2.61m x 3.15m  
8'7" x 10'4"

#### Bedroom 4

3.53m x 2.28m  
11'7" x 7'6"

#### Bathroom

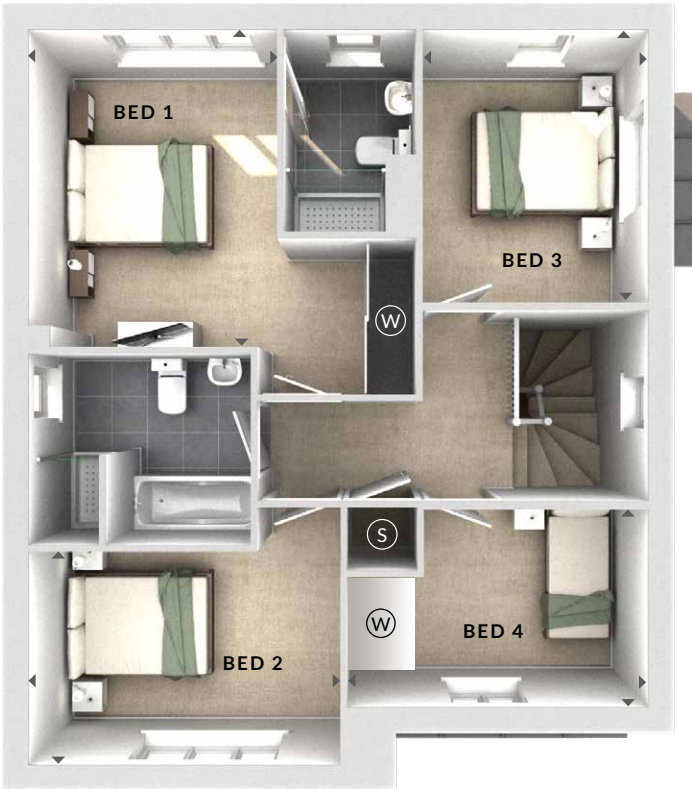

First Floor

### Ground Floor:

#### Lounge

4.11m x 4.15m  
13'6" x 13'7"

#### Kitchen / Dining / Family

7.20m x 4.25m  
23'8" x 13'11"

#### (W) Wardrobes

\*Wardrobes to bed 4 indicated in selected plots only. Please speak to Sales Advisor for details.

#### (U) Utility

#### (C) Cloaks

#### ◀▶ Measurement Points

#### △ External Access



Ground Floor