

Located at the Gateway to  
Manchester City Centre

# ARCH WAY 3

MULTI-LET WORKSPACE

Flexible Terms Available | 33,065 SQ FT | Archway 3 Birley Fields Manchester M15 5QJ



# A Vibrant and Unique Workspace



Secure parking



Collaborative Spaces



Shower facilities



Gym



Refreshment Facilities



Biophilia

With 33,000 sqft of commercial space, Archway 3 offers the dynamic vibrancy of city working but in the leafier University Corridor. On the edge of the city centre and the science park and 200m from the new Manchester Metropolitan campus, this creative hub boasts urban working without city centre commuting.

The ground floor reception gives way to Munchy's Café on one side and a tranquil outdoor seating area on the other. With real and artificial trees and plants, the design brings the outdoors in to create a new style of collaborative workspace.



# Gateway to Manchester City Centre



Archway 3 has a creative vibe that resonates through its eclectic mix of facilities. Due to the location on the edge of the city and it's abundant parking, it is extremely accessible when commuting

by car. And for train travellers arriving into Piccadilly and visitors from Manchester Airport, the office is less than 15 minutes by taxi.  
**Archway 3, M15 5QJ**



## Distances to

	Piccadilly Station	1.7 miles	8 minute drive	35 minute walk
	Deansgate Station	1.4 miles	6 minute drive	20 minute walk
	Manchester Airport	7.7 miles	16 minute drive	

	M60 (South)	3.5 miles	11 minute drive
	M60 (West)	8.6 miles	19 minute drive
	M56	4.8 miles	13 minute drive

# Community & Collaboration

Munchy's Café, with its healthy and hearty breakfast and lunch menus, is a hangout for premiership footballers, music recording artists and office residents. The venue's leisure facilities sit alongside a stylish black oak boardroom creating a relaxed environment in which to conduct business.

A collaboration with Pulse Fitness, the 3 Archway Gym has everything from treadmills to technogyms and caters for the occasional trainer and the fitness fanatic. Open from morning to night for residents and guests, the facility encourages fitness of body and mind just metres from your workstation.



Five changing/  
shower facilities



Outdoor  
yoga terrace



Healthy food  
options GF/Vg

# Dynamic Office Environments

A range of office sizes and arrangements exist within the ground and first floors. With additional kitchen facilities and bespoke designs available, residents can tailor the environment to their own operational needs and create their own space within the wider community.



# Make Your Own Ground Floor

Currently a blend of offices and communal facilities, the ground floor has an additional section undertaking conversion into office and meeting room space.

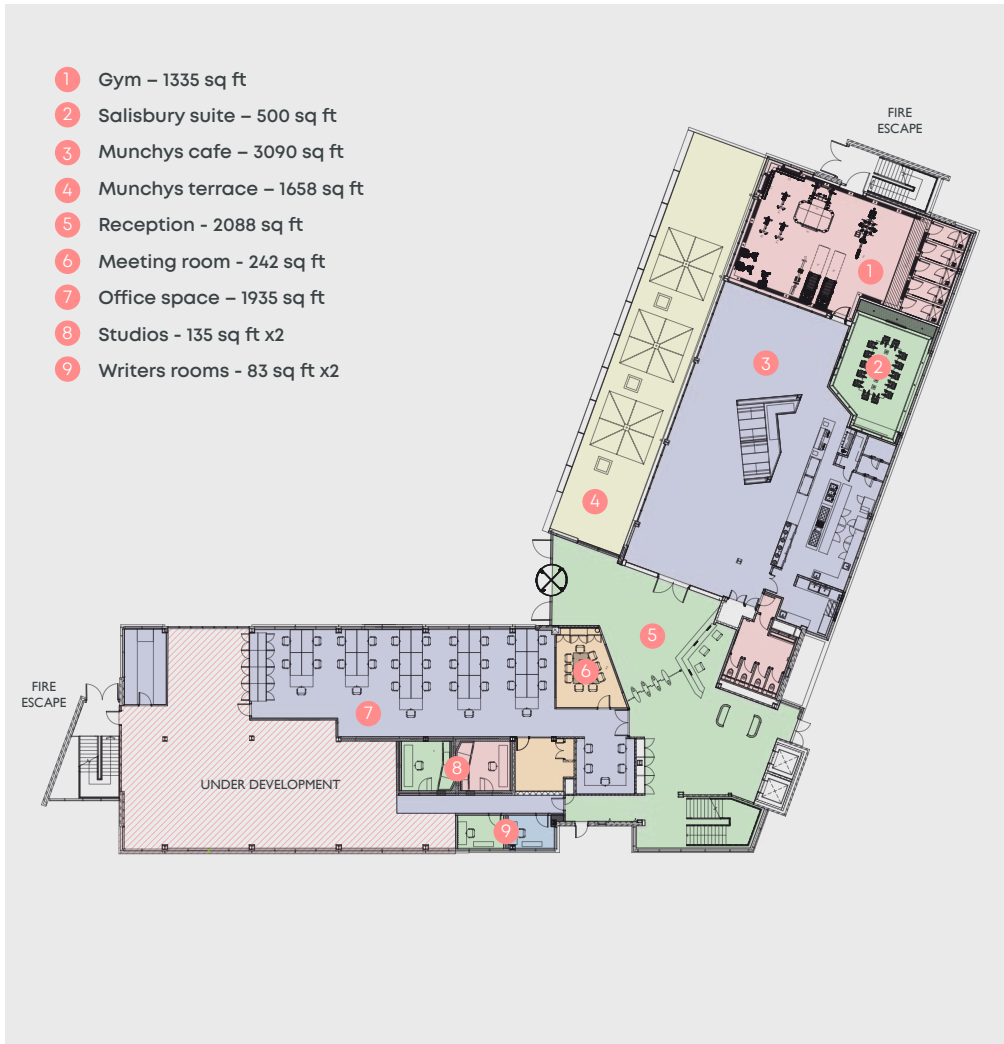

# Space To Make Your Own

With metallic false floors and industrial style open ceilings, the capacious floor space feels both innovative and expansive. Large windows throughout allow for a bright and airy workspace.

- 1 Open plan office space – 5210 sq ft
- 2 Tailored office space – 1260 sq ft
- 3 Tailored office space – 355 sq ft
- 4 Tailored office space – 678 sq ft
- 5 Tailored office space – 2210 sq ft
- 6 Boardroom – 358 sq ft
- 7 Kitchen/dining - 840 sq ft
- 8 Meeting Room – 280 sq ft



# Turn Key Office Space

With multi-purpose spaces on the second floor and mezzanine, there is a real opportunity to hit the ground running with tailored facilities of the highest quality.

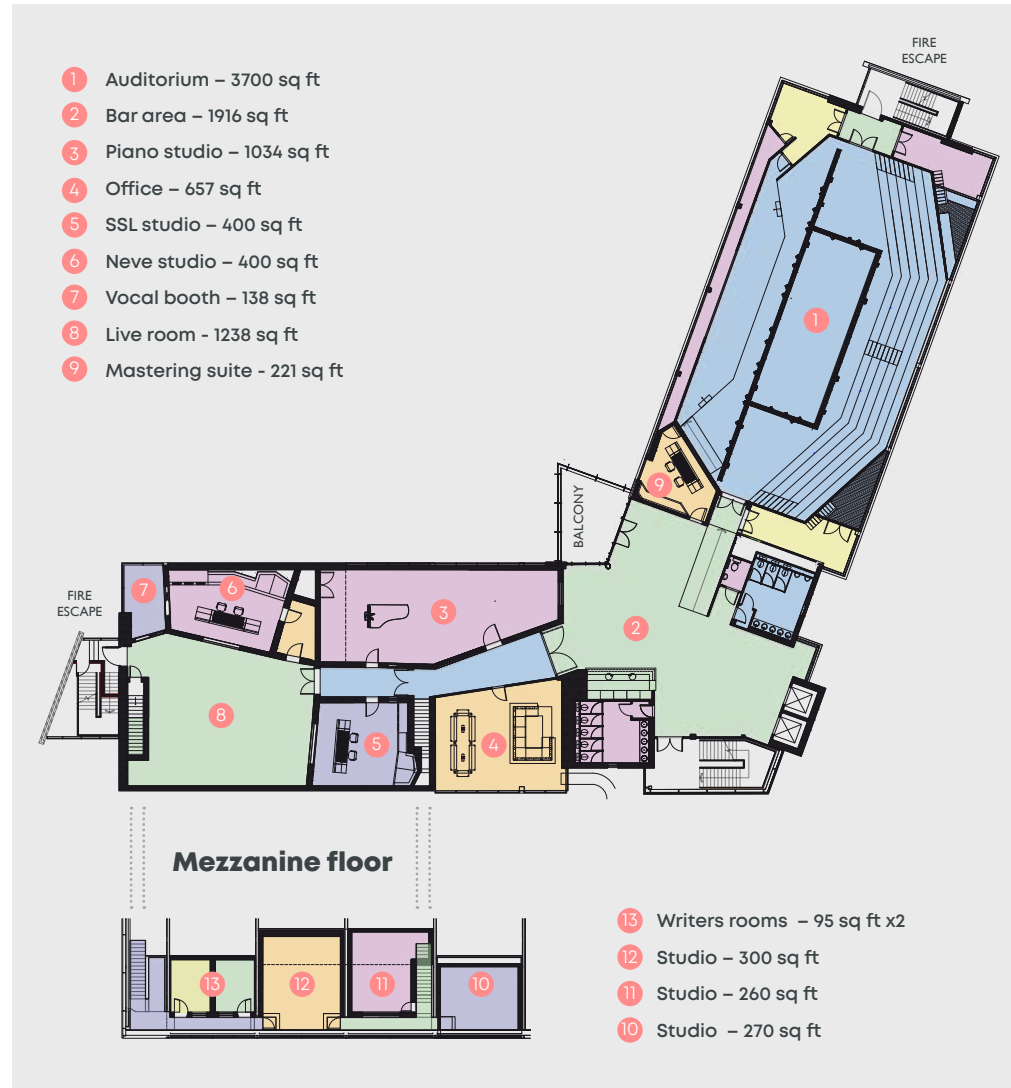



# Event Facilities

This extraordinary venue space on the 2nd floor offers facilities for conferences, music concerts, performances and all-company meetings. The 450 seat theatre and bar area combine to provide a unique space in Manchester's commercial scene.

Alongside the full AV set up and lighting rig, the impressive 140sqft screen makes the space versatile to any occasion and gives residents access to a venue that is unrivalled in the city.



140sq ft  
screen



Superclub grade  
sound system



450 theatre  
capacity

# World Class Studios



Bösendorfer

Solid State Logic  
SOUND || VISION

Neve

With two of the world's most prestigious sound desks at its heart, Manchester Recording Studios is like nothing outside of London. The two industry leading studios feed into a Live Room for everything from bands to orchestras.

A Bosendorfer Piano room, mastering suite and 6 mixed size writers rooms allow the facility to be truly multi-genre and available to everyone from touring bands to breakthrough artists. A management suite completes the two-storey picture.

