



Retford Railway Station, Station Road, Retford DN22 7DE

**TO LET**

Former Station House

1,708 Sq Ft  
(159 Sq M)



# Retford Railway Station, Station Road, Retford DN22 7DE

## DESCRIPTION

An exciting opportunity to lease the whole or part of the historic former Victorian tea room and World War II kitchens within the Grade II Listed station.

The premises are ideally suited for conversion to bar/restaurant/office/B&B. Investment required, long lease available, flexible terms, rental offers are invited based on a percentage of turnover net of VAT which is to be underpinned by a minimum guaranteed rent. Potential for Railway Heritage funding assistance.

- ✓ **Grade II Listed Station**
- ✓ **Benefits from mains electricity, water and drainage**
- ✓ **Property in need of renovation**
- ✓ **Regular services to Leeds, London and Edinburgh**
- ✓ **Located on the fringe of the town centre**



## LOCATION

The Grade II listed station is located in the north Nottinghamshire town of Retford and benefits from regular trains to London, Leeds and Edinburgh. The station is located on the fringe of the town centre in a mainly residential area and benefits from approximately 700,000 passengers per annum.

## ACCOMMODATION

Net Internal Areas	sq ft	sq m
Ground	712	66
First	996	93
Basement	1,500	139

## VAT

All prices, premiums and rents, etc are quoted exclusive of VAT at the prevailing rate.

## LEGAL COSTS

The tenant will be responsible for the landlords legal costs incurred in the drafting and completion of the lease.

## BUSINESS RATES

The tenant will be responsible for all business rates incurred in connection with their occupation of this unit.

## TERMS

A Tripartite lease for a term to be agreed is available.

## EPC

The property has an EPC rating of D (91).



Ground Floor

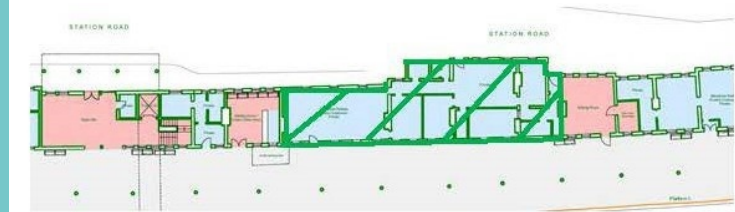

First Floor

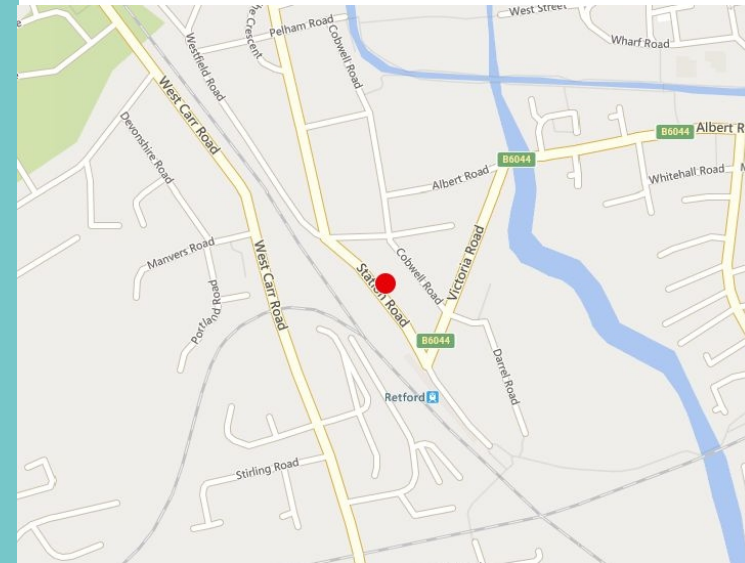

[lsh.co.uk](http://lsh.co.uk)

© Lambert Smith Hampton. Details of Lambert Smith Hampton (LSH) can be viewed on our website [www.lsh.co.uk](http://www.lsh.co.uk) This document is for general informative purposes only. The information in it is believed to be correct, but no express or implied representation or warranty is made by LSH as to its accuracy or completeness, and the opinions in it constitute our judgement as of this date but are subject to change. Reliance should not be placed upon the information, forecasts and opinions for any purpose, and no responsibility or liability, whether in negligence or otherwise, is accepted by LSH or by any of its directors, officers, employees, agents or representatives for any loss arising from any use of this document or its contents or otherwise arising in connection with this document. All rights reserved. No part of this document may be transmitted or reproduced in any material form by any means, electronic, recording, mechanical, photocopying or otherwise, or stored in any information storage or retrieval system of any nature, without the prior written permission of the copyright holder, except in accordance with the provisions of the Copyright Designs and Patents Act 1988. Warning: the doing of an unauthorised act in relation to a copyright work may result in both a civil claim for damages and criminal prosecution. Regulated by RICS 19-Apr-2023

## VIEWING & FURTHER INFORMATION

Viewing strictly by prior appointment:



Jason Pinkett  
020 7198 2136  
[jpinkett@lsh.co.uk](mailto:jpinkett@lsh.co.uk)

