





College Road, Hoddesdon, EN11 9DJ

Westwood Leber are delighted to bring to the market this rarely available three double-bedroom detached family home, located on this highly sought-after private road. This property offers fantastic living accommodation throughout, comprising a large open lounge/dining room with air-conditioning, naturally lit conservatory and modern fitted kitchen. Further benefits include fitted wardrobes in the first and second bedrooms, ample storage throughout, downstairs w/c, separate utility space, new combi-boiler, approximately 100ft well-landscaped rear garden, outbuilding with power and internet setup perfectly for a home office, and a drive to the front for multiple cars. An internal viewing is highly recommended!



 WESTWOODLEBER

 WESTWOODLEBER
LET US GUIDE YOU HOME

Ground Floor
Approx. 96.4 sq. metres (1037.3 sq. feet)



First Floor
Approx. 48.9 sq. metres (526.2 sq. feet)

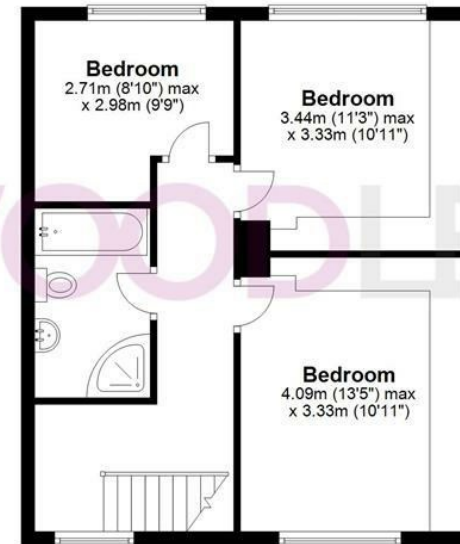

Outbuilding
Approx. 17.2 sq. metres (184.7 sq. feet)



Total area: approx. 162.4 sq. metres (1748.1 sq. feet)

FOR ILLUSTRATIVE PURPOSES ONLY. NOT TO SCALE. Whilst every attempt had been made to ensure the accuracy of the floor plan shown, all measurements, positioning, fixtures, features, fittings and any other data shown are an approximate interpretation for illustrative purposes only and are not to scale. No responsibility is taken for any error, omission, miss-statement or use of data shown. Property marketing provided by Westwood Leber.
Plan produced using PlanUp.











WESTWOODLEBER

WESTWOODLEBER
LET US GUIDE YOU HOME