

Duke Street, Hoddesdon, EN11 8JD

Westwood Leber are delighted to bring to the market this immaculately presented, three bedroom family home located just a short walk from Rye House Rail Station and Hoddesdon Town Centre. This property has been tastefully updated by the current owners and offers excellent living accommodation throughout comprising: a large living room/ dining room, well sized modern fitted kitchen, a first floor four piece bathroom and a rear garden. An internal viewing is highly recommended!



WESTWOODLEBER

WESTWOODLEBER
LET US GUIDE YOU HOME

Ground Floor

Approx. 36.6 sq. metres (393.5 sq. feet)

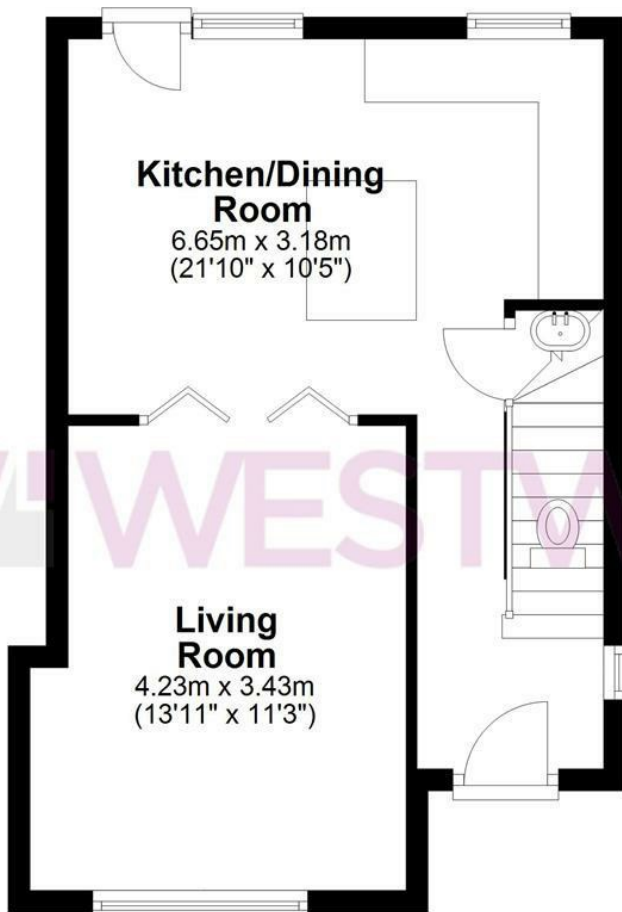

First Floor

Approx. 37.0 sq. metres (398.6 sq. feet)

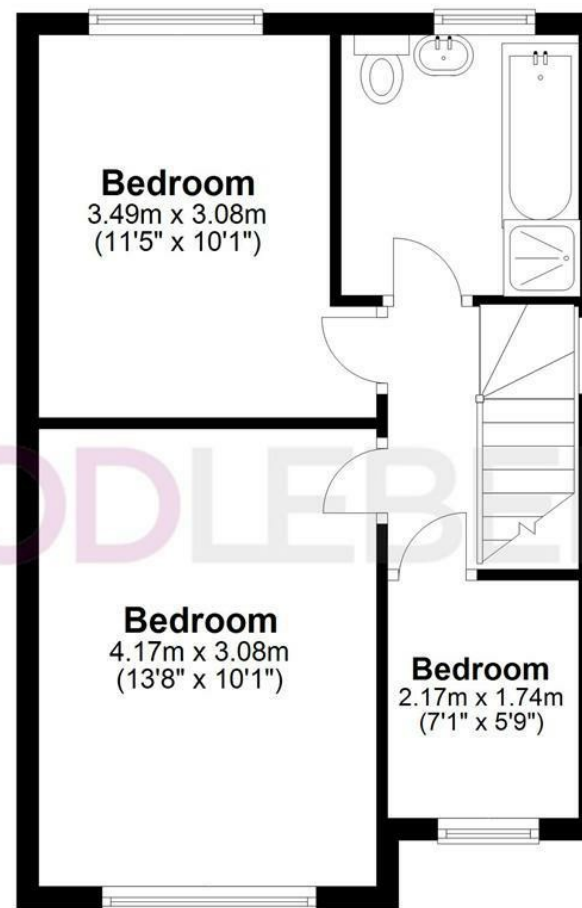

Total area: approx. 73.6 sq. metres (792.1 sq. feet)

THE FLOORPLAN IS FOR ILLUSTRATIVE PURPOSES ONLY AND IS NOT TO SCALE. Measurements and features are approximate and may differ from the actual property. Verify all details independently; no liability is accepted for errors or omissions.

Property marketing provided by www.fotomarketing.co.uk





