



WESTWOODLEBER

**WESTWOODLEBER**  
LET US GUIDE YOU HOME

Buryholme, Broxbourne, EN10 6PE  
Offers in excess of £485,000





## Buryholme, Broxbourne, EN10 6PE

Westwood Leber are delighted to bring to the market this exceptional four bedroom well extended semi-detached family home that has been tastefully updated by the current owners located on this sought after residential close just a short walk from Broxbourne school. This property boasts a wealth of desired features including a larger than average living room/dining room with wooden flooring throughout, a modern fitted kitchen leading to a low maintenance rear garden. Further benefits include off-street parking for multiple cars, a downstairs w/c and side access to the garden. An internal viewing is highly recommended!





**WESTWOODLEBER**

**WESTWOODLEBER**  
LET US GUIDE YOU HOME



## Ground Floor

Approx. 61.3 sq. metres (659.6 sq. feet)



## First Floor

Approx. 47.8 sq. metres (514.9 sq. feet)

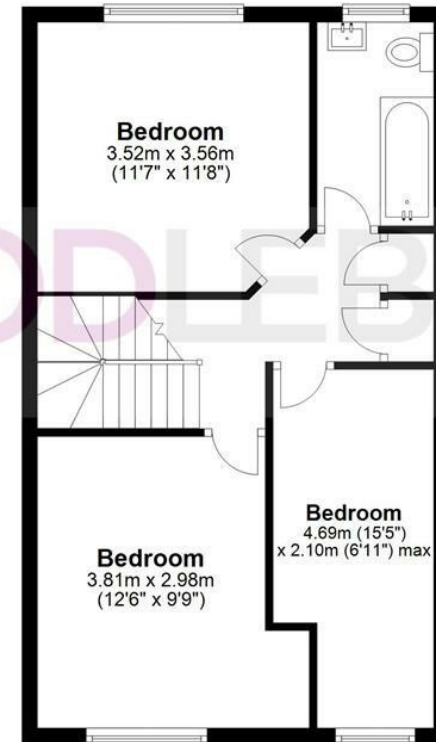

Total area: approx. 109.1 sq. metres (1174.5 sq. feet)

FOR ILLUSTRATIVE PURPOSES ONLY. NOT TO SCALE. Whilst every attempt had been made to ensure the accuracy of the floor plan shown, all measurements, positioning, fixtures, features, fittings and any other data shown are an approximate interpretation for illustrative purposes only and are not to scale. No responsibility is taken for any error, omission, miss-statement or use of data shown. Property marketing provided by Westwood Leber.  
Plan produced using PlanUp.



















