







## Hillside, Hoddesdon, EN11 8RW

Westwood Leber are delighted to bring to the market this one-bedroom apartment, set in a well-maintained development. Situated on the ground floor, this property is an ideal first-time purchase or investment opportunity. It boasts a spacious reception room, a separate kitchen, a three-piece bathroom suite and a well sized bedroom. Additionally, the property benefits from a bright private balcony off the living room, offering a unique outdoor space rarely available in a flat like this.

Externally, there is allocated undercover parking, access to well-maintained communal gardens, and the added advantage external storage space. The property is located a short distance from Hoddesdon town centre, with its many shops and amenities, and is well situated for transport links via the A10, while the local train station at Rye House offers access to London Liverpool Street.



**W** WESTWOODLEBER

**W** WESTWOODLEBER  
LET US GUIDE YOU HOME



**Ground Floor**  
Approx. 51.8 sq. metres (557.1 sq. feet)

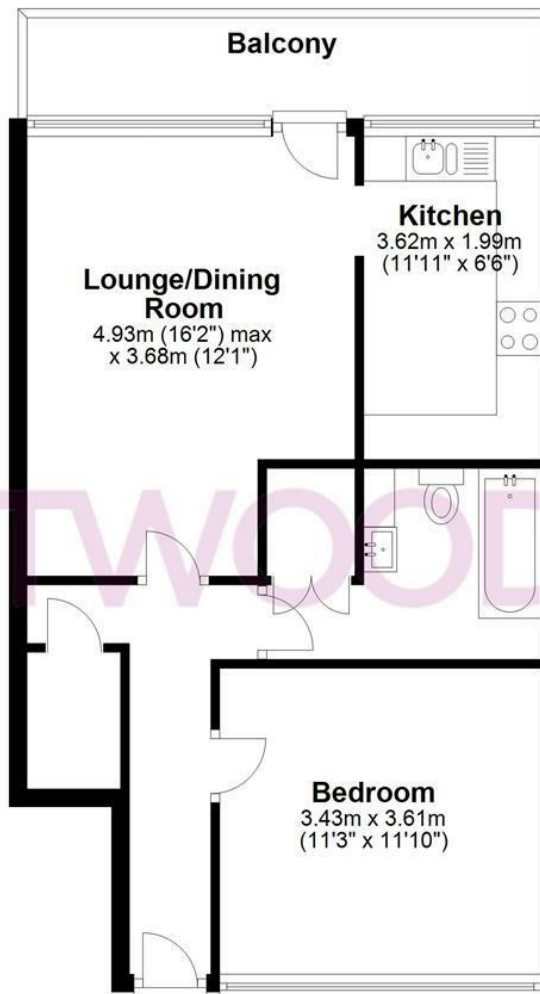

Total area: approx. 51.8 sq. metres (557.1 sq. feet)

THE FLOORPLAN IS FOR ILLUSTRATIVE PURPOSES ONLY AND IS NOT TO SCALE. Measurements and features are approximate and may differ from the actual property. Verify all details independently; no liability is accepted for errors or omissions.

Property marketing provided by [www.fotomarketing.co.uk](http://www.fotomarketing.co.uk)















