







## Beechfield, Hoddesdon, EN11 9QL

Westwood Leber is thrilled to present this impressive, generously-sized three/four-bedroom family home, ideally located on a highly sought-after residential road in Hoddesdon. This semi-detached property has been tastefully updated by the current owners and offers versatile living spaces throughout.

The accommodation includes a spacious open-plan kitchen/diner, a sizable lounge, and a separate snug, making it perfect for family gatherings and entertaining. Upstairs, you will find three well-proportioned bedrooms along with a superb family bathroom. Additionally, the property features a convenient fourth bedroom on the ground floor, complete with a separate shower room, making it ideal for use as an annexe or for rental potential.

Externally, the property is complemented by a well-maintained rear garden of perfect size and a front driveway that provides parking for three vehicles. We highly recommend scheduling an internal viewing to fully appreciate all that this family home has to offer.





**WESTWOODLEBER**

**WESTWOODLEBER**  
LET US GUIDE YOU HOME

**Ground Floor**  
Approx. 60.3 sq. metres (649.2 sq. feet)

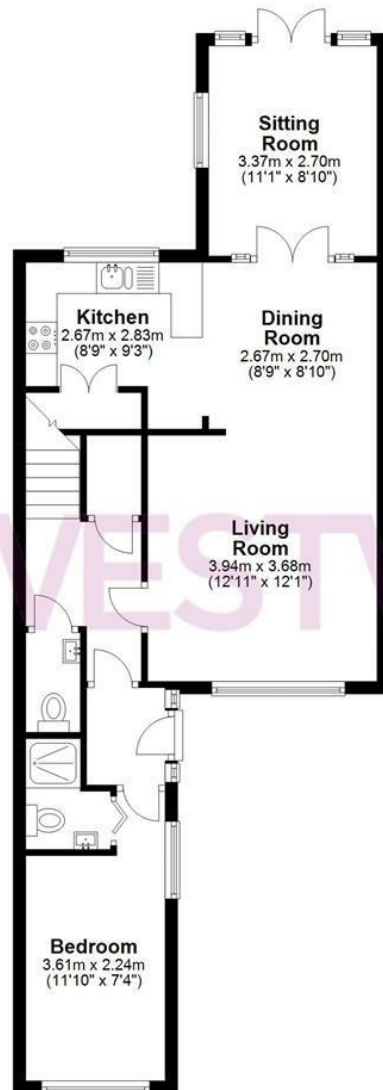

**First Floor**  
Approx. 37.8 sq. metres (406.9 sq. feet)

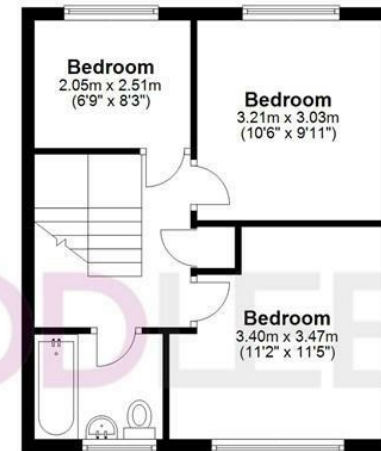

Total area: approx. 98.1 sq. metres (1056.1 sq. feet)

THE FLOORPLAN IS FOR ILLUSTRATIVE PURPOSES ONLY AND IS NOT TO SCALE. Measurements and features are approximate and may differ from the actual property. Verify all details independently; no liability is accepted for errors or omissions.

Property marketing provided by [www.fotomarketing.co.uk](http://www.fotomarketing.co.uk)



















