



WESTWOODLEBER

**WESTWOODLEBER**  
LET US GUIDE YOU HOME

Ware Road, Hoddesdon, EN11 9EU  
£650,000





## Ware Road, Hoddesdon, EN11 9EU

**\*\* CHAIN FREE \*\*** Westwood Leber are delighted to offer this magnificent four bedroom family home that has been completely renovated with accommodation now reaching approximately 1500 sq ft. This property offers fantastic living accommodation throughout including a utility room, ground floor w/c, two bathrooms, large front driveway, garage, a luxury 25ft x 21ft L shaped kitchen/family room with bi-folding doors leading out to a fabulous 100ft rear garden and a large outer building with bi-folding doors. Internal Viewing is highly recommended!





**WESTWOODLEBER**

**WESTWOODLEBER**  
LET US GUIDE YOU HOME

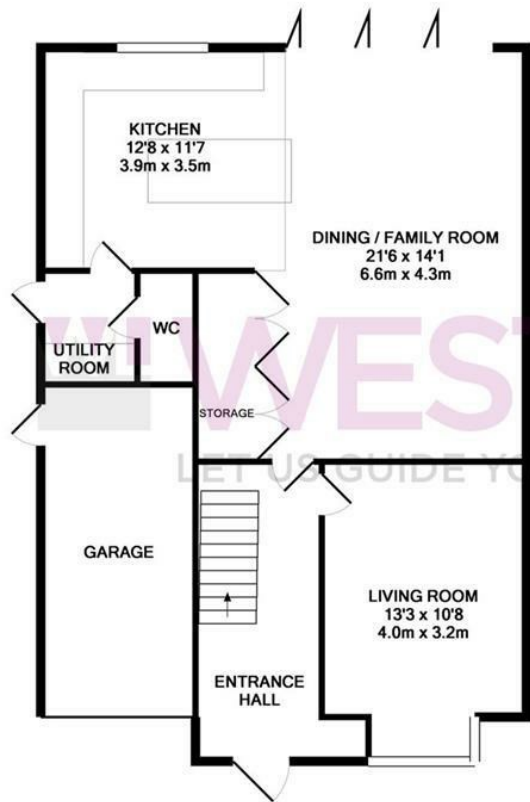

GROUND FLOOR  
APPROX. FLOOR  
AREA 910 SQ.FT.  
(84.5 SQ.M.)



1ST FLOOR  
APPROX. FLOOR  
AREA 558 SQ.FT.  
(51.9 SQ.M.)



**TOTAL APPROX. FLOOR AREA 1468 SQ.FT. (136.4 SQ.M.)**

Whilst every attempt has been made to ensure the accuracy of the floor plan contained here, measurements of doors, windows, rooms and any other items are approximate and no responsibility is taken for any error, omission, or mis-statement. This plan is for illustrative purposes only and should be used as such by any prospective purchaser. The services, systems and appliances shown have not been tested and no guarantee as to their operability or efficiency can be given

Made with Metropix ©2019

















WESTWOODLEBER



WESTWOODLEBER



WESTWOODLEBER



WESTWOODLEBER









WESTWOODLEBER



WESTWOODLEBER



WESTWOODLEBER



WESTWOODLEBER



