

## Smarts Green, Cheshunt, Waltham Cross, EN7 6BA

Westwood Leber are delighted to bring to the market this well-presented three-bedroom end-terraced family home, ideally positioned in this sought-after Cheshunt location.

This property offers spacious and versatile accommodation throughout, comprising a generous living room, a bright dining area, and a well-fitted kitchen, perfect for modern family living and entertaining. The ground floor also benefits from a convenient downstairs W.C.

On the first floor, there are three well-proportioned bedrooms and a modern family bathroom, creating a comfortable and functional layout ideal for growing families or first-time buyers alike.

Externally, the property boasts a garage attached at the front, providing excellent storage or parking options, along with a well-maintained rear garden ideal for outdoor dining and relaxation.

Set within a quiet residential area, this home is perfectly placed close to highly regarded schools, local shops, and transport links, including Cheshunt and Theobalds Grove Stations, offering superb access into London and surrounding areas. An early viewing is highly recommended!



WESTWOODLEBER

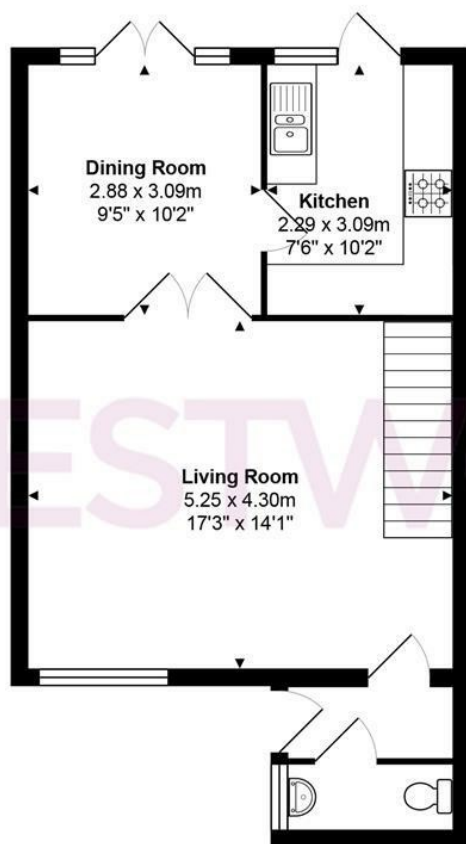

**Ground Floor**

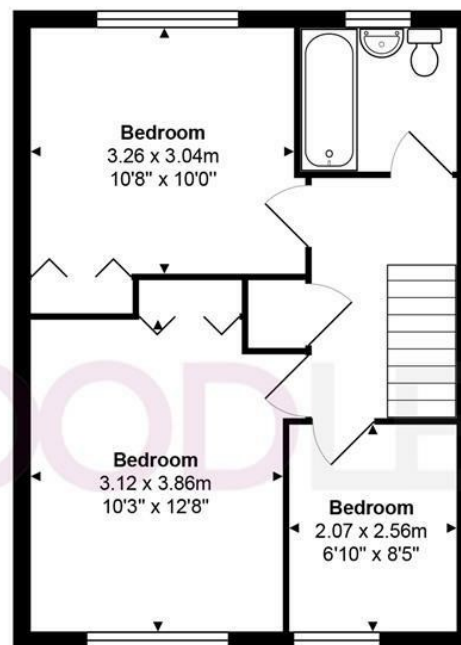

**First Floor**

Total Area: approx. 82.6 m<sup>2</sup> ... 890 ft<sup>2</sup>

THE FLOORPLAN IS FOR ILLUSTRATIVE PURPOSES ONLY AND IS NOT TO SCALE.  
Measurements and features are approximate and may differ from the actual property. Verify all details independently; no liability is accepted for errors or omissions.

Property marketing provided by [www.fotomarketing.co.uk](http://www.fotomarketing.co.uk)











