

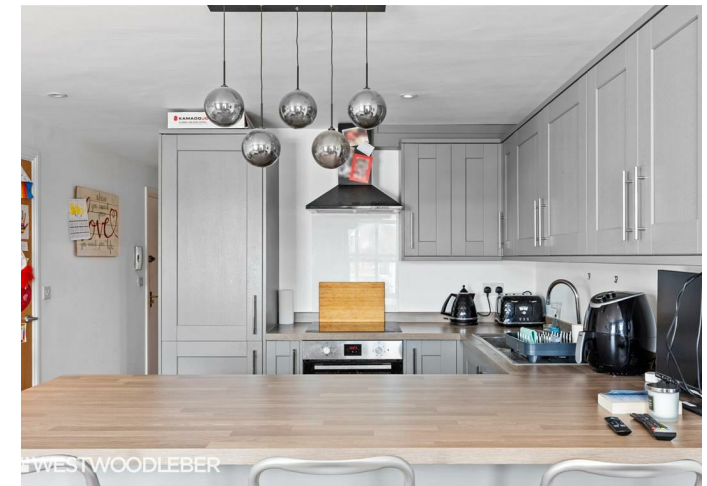

WESTWOODLEBER

WESTWOODLEBER
LET US GUIDE YOU HOME

Brewery Road, Hoddesdon, EN11 8HH
£199,995



Brewery Road, Hoddesdon, EN11 8HH

**** PERFECT FOR FIRST TIME BUYERS OR AN INVESTMENT OPPORTUNITY **** Westwood Leber are delighted to bring to the market this immaculately presented one double bedroom converted apartment in the heart of Hoddesdon's town centre. This fantastic property offers well-designed living space throughout, featuring a contemporary open plan kitchen/lounge, a spacious double bedroom, and a modern three-piece bathroom suite. Further benefits include off-street allocated parking and a town centre location. An internal viewing is highly recommended!



WESTWOODLEBER

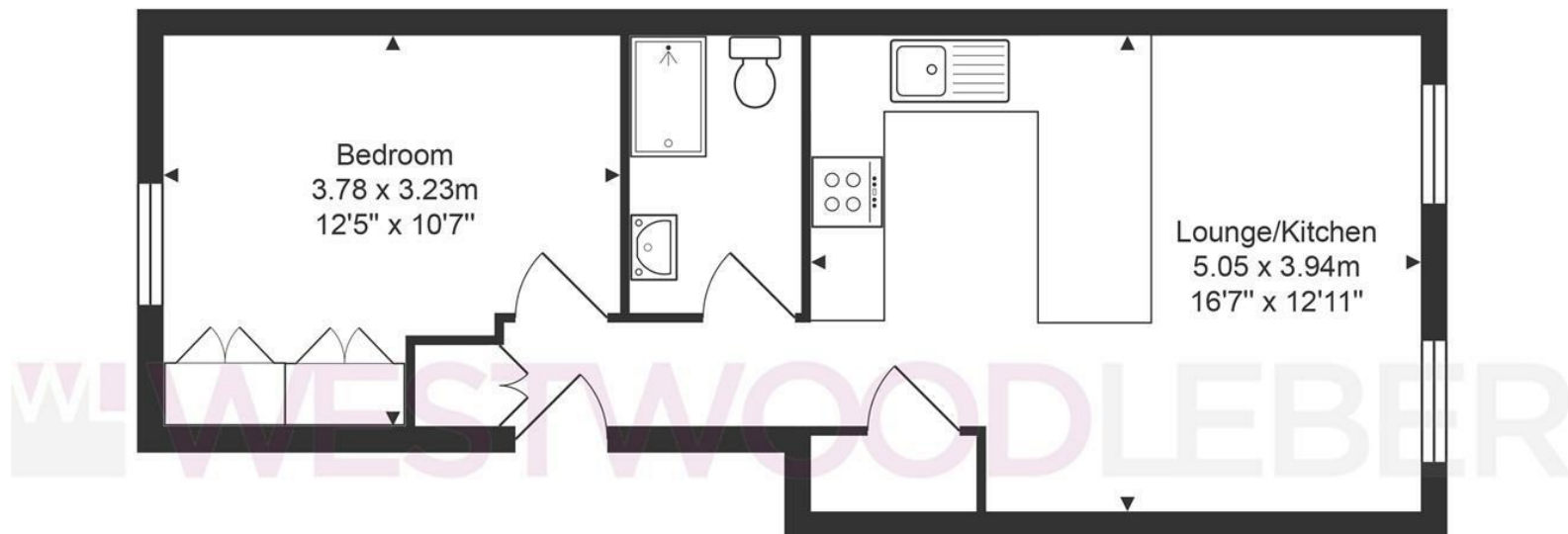

Apartment

Total Area: approx. 37.2 m² ... 400 ft²

THE FLOORPLAN IS FOR ILLUSTRATIVE PURPOSES ONLY AND IS NOT TO SCALE.

Measurements and features are approximate and may differ from the actual property. Verify all details independently; no liability is accepted for errors or omissions.

Property marketing provided by www.fotomarketing.co.uk





