





Rye Road, Hoddesdon, EN11 0HP

Westwood Leber is thrilled to present this exceptional three-bedroom period property, ideally located within walking distance of Rye House Rail Station and Hoddesdon town centre. Beautifully extended and thoughtfully laid out for family living, this home exudes character and charm.

Offering deceptively spacious accommodation throughout, it features a luxurious kitchen with a monarch water softener and a beautiful lounge/diner, both of which boast a wealth of character on the ground floor. Moving upstairs, you'll find a stylish first-floor bathroom, two well-proportioned bedrooms, and the added benefit of a large master suite on the top floor with an en-suite bathroom which includes a salamander pump. The property also boasts a large, landscaped garden. We highly recommend scheduling an early viewing to fully appreciate this remarkable home!



WESTWOODLEBER

WESTWOODLEBER
LET US GUIDE YOU HOME

Ground Floor

Approx. 44.4 sq. metres (477.8 sq. feet)

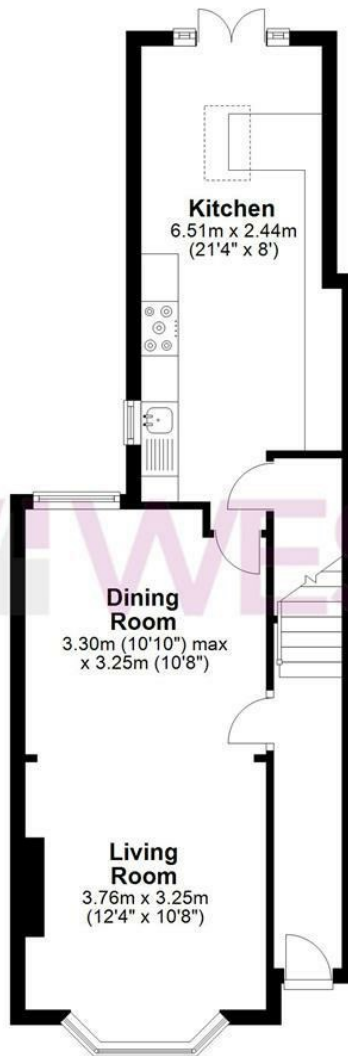

First Floor

Approx. 37.0 sq. metres (398.3 sq. feet)



Second Floor

Approx. 27.1 sq. metres (292.1 sq. feet)



Total area: approx. 143.1 sq. metres (1540.1 sq. feet)

THE FLOORPLAN IS FOR ILLUSTRATIVE PURPOSES ONLY AND IS NOT TO SCALE. Measurements and features are approximate and may differ from the actual property. Verify all details independently; no liability is accepted for errors or omissions.

[Property marketing provided by www.fotomarketing.co.uk](http://www.fotomarketing.co.uk)









