





The Hyde, Ware, SG12 0ER

Westwood Leber are delighted to bring to the market this well presented one bedroom first floor apartment in this sought after residential close on The Hyde, Ware. This property offers great living accommodation with a large family lounge, and larger than average bedroom. Further benefits include an allocated parking space, three piece bathroom suite and modern fitted kitchen. An internal viewing is highly recommended!



W^L WESTWOODLEBER

W^L WESTWOODLEBER
LET US GUIDE YOU HOME

Ground Floor

Approx. 44.1 sq. metres (474.9 sq. feet)

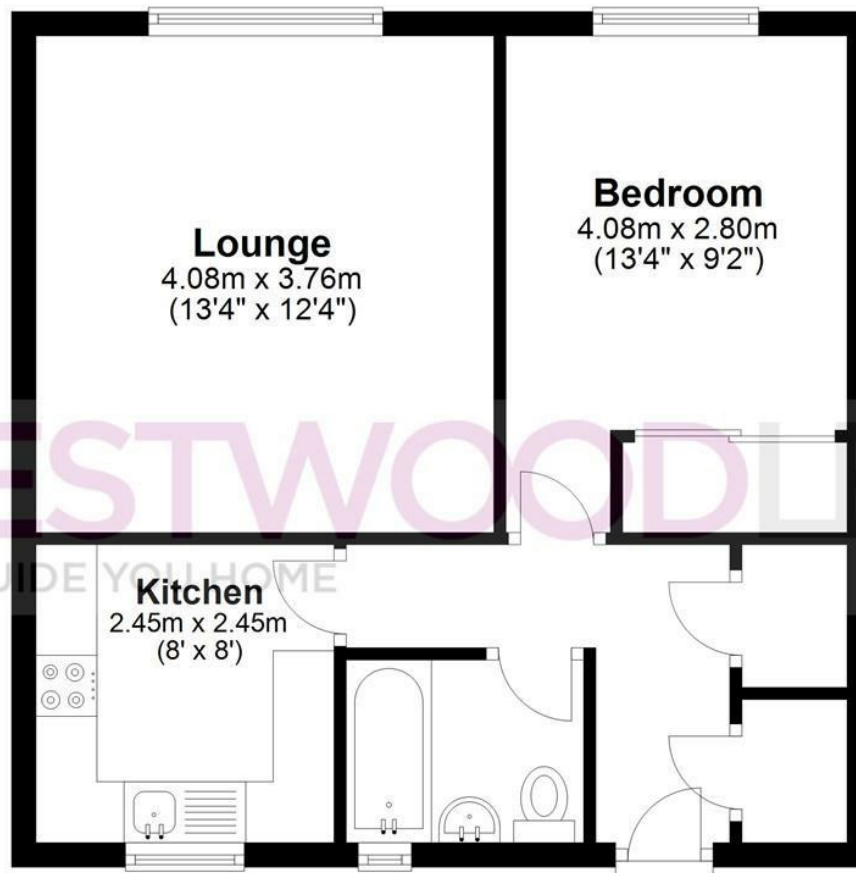

Total area: approx. 44.1 sq. metres (474.9 sq. feet)

FOR ILLUSTRATIVE PURPOSES ONLY. NOT TO SCALE. Whilst every attempt had been made to ensure the accuracy of the floor plan shown, all measurements, positioning, fixtures, features, fittings and any other data shown are an approximate interpretation for illustrative purposes only and are not to scale. No responsibility is taken for any error, omission, miss-statement or use of data shown. Property marketing provided by Westwood

Leber.

Plan produced using PlanUp.

Energy Efficiency Rating		
	Current	Potential
Very energy efficient - lower running costs		
(92 plus) A		
(81-91) B		
(69-80) C	75	75
(55-68) D		
(39-54) E		
(21-38) F		
(1-20) G		
Not energy efficient - higher running costs		
England & Wales EU Directive 2002/91/EC		
Environmental Impact (CO ₂) Rating		
	Current	Potential
Very environmentally friendly - lower CO ₂ emissions		
(92 plus) A		
(81-91) B		
(69-80) C		
(55-68) D		
(39-54) E		
(21-38) F		
(1-20) G		
Not environmentally friendly - higher CO ₂ emissions		
England & Wales EU Directive 2002/91/EC		

