





Clements Close, Puckeridge, Ware, SG11 1DE

Westwood Leber are delighted to bring to the market this beautifully presented, two bedroom house positioned perfectly within this quiet cul-de-sac in Puckeridge. The property has been tastefully updated by the current owners and benefits from a deceptively spacious ground floor living space including a large open plan lounge/diner, separate kitchen, downstairs w/c and a stunning, low maintenance rear garden. The property also benefits from having 2 allocated parking spaces with a south facing rear garden and has further scope to extend STPP. We would highly recommend an internal viewing.



Ground Floor

Approx. 39.0 sq. metres (420.1 sq. feet)

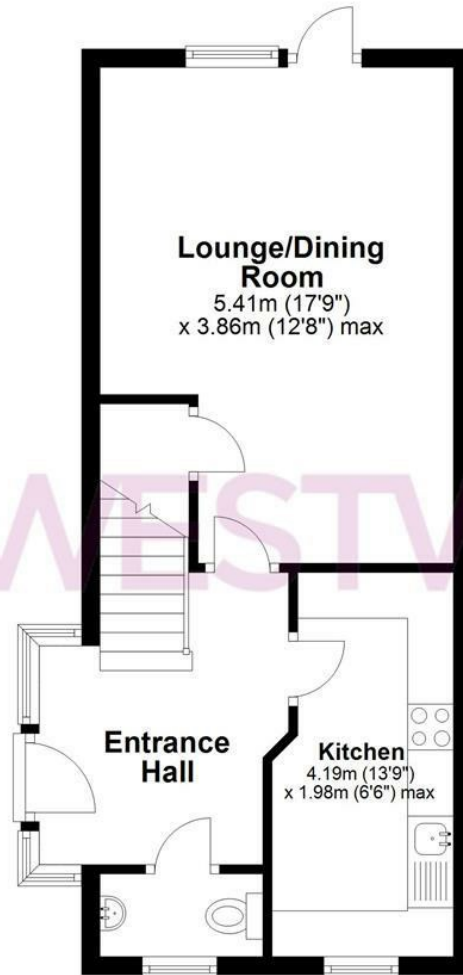

First Floor

Approx. 37.4 sq. metres (403.1 sq. feet)

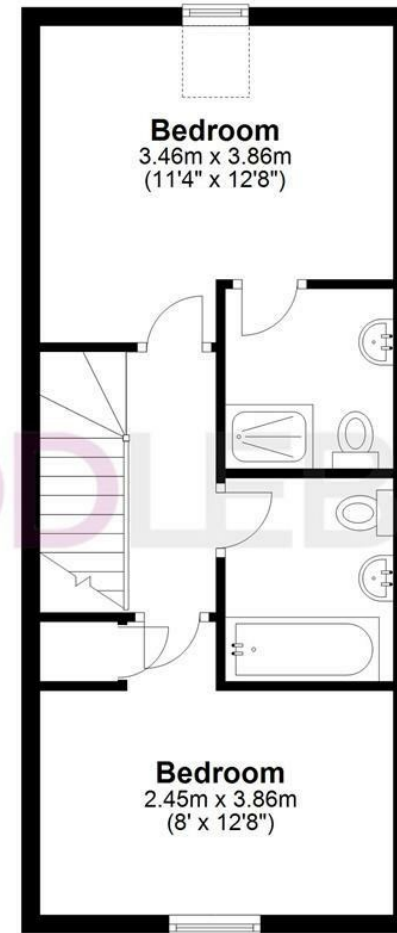

Total area: approx. 76.5 sq. metres (823.2 sq. feet)

THE FLOORPLAN IS FOR ILLUSTRATIVE PURPOSES ONLY AND IS NOT TO SCALE. Measurements and features are approximate and may differ from the actual property. Verify all details independently; no liability is accepted for errors or omissions.

Property marketing provided by www.fotomarketing.co.uk
Plan produced using PlanUp.









