





Cecil Road, Hertford, SG13 8HP

Westwood Leber is proud to present this immaculately presented three-bedroom family home, ideally situated on a highly sought-after residential road in Hertford. Within walking distance to the popular SG13 schools and both Hertford North and East stations, this property is perfectly positioned for convenient access to local amenities and transport links. Tastefully updated by the current owners, the property offers an abundance of space, featuring a spacious modern lounge/diner and a well-sized, fully-fitted kitchen. The home also boasts three comfortable bedrooms, providing ample living space for families. Additional highlights include a well-kept rear garden, side access and off-street parking for two vehicles on the driveway. We highly recommend scheduling a viewing!



W^L WESTWOODLEBER

W^L WESTWOODLEBER
LET US GUIDE YOU HOME

Ground Floor

Approx. 35.4 sq. metres (381.1 sq. feet)

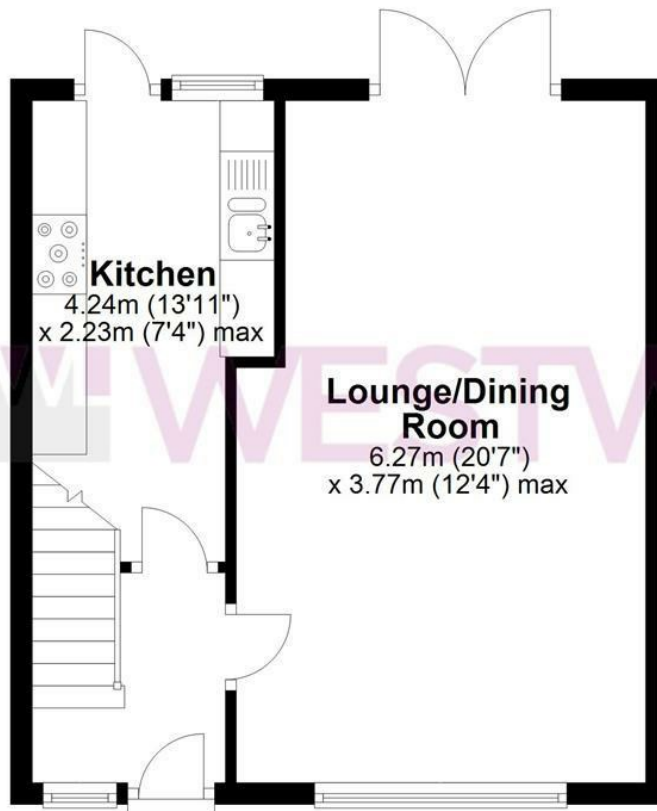

First Floor

Approx. 39.6 sq. metres (426.7 sq. feet)



Total area: approx. 75.0 sq. metres (807.8 sq. feet)

THE FLOORPLAN IS FOR ILLUSTRATIVE PURPOSES ONLY AND IS NOT TO SCALE. Measurements and features are approximate and may differ from the actual property. Verify all details independently; no liability is accepted for errors or omissions.

Property marketing provided by www.fotomarketing.co.uk







