

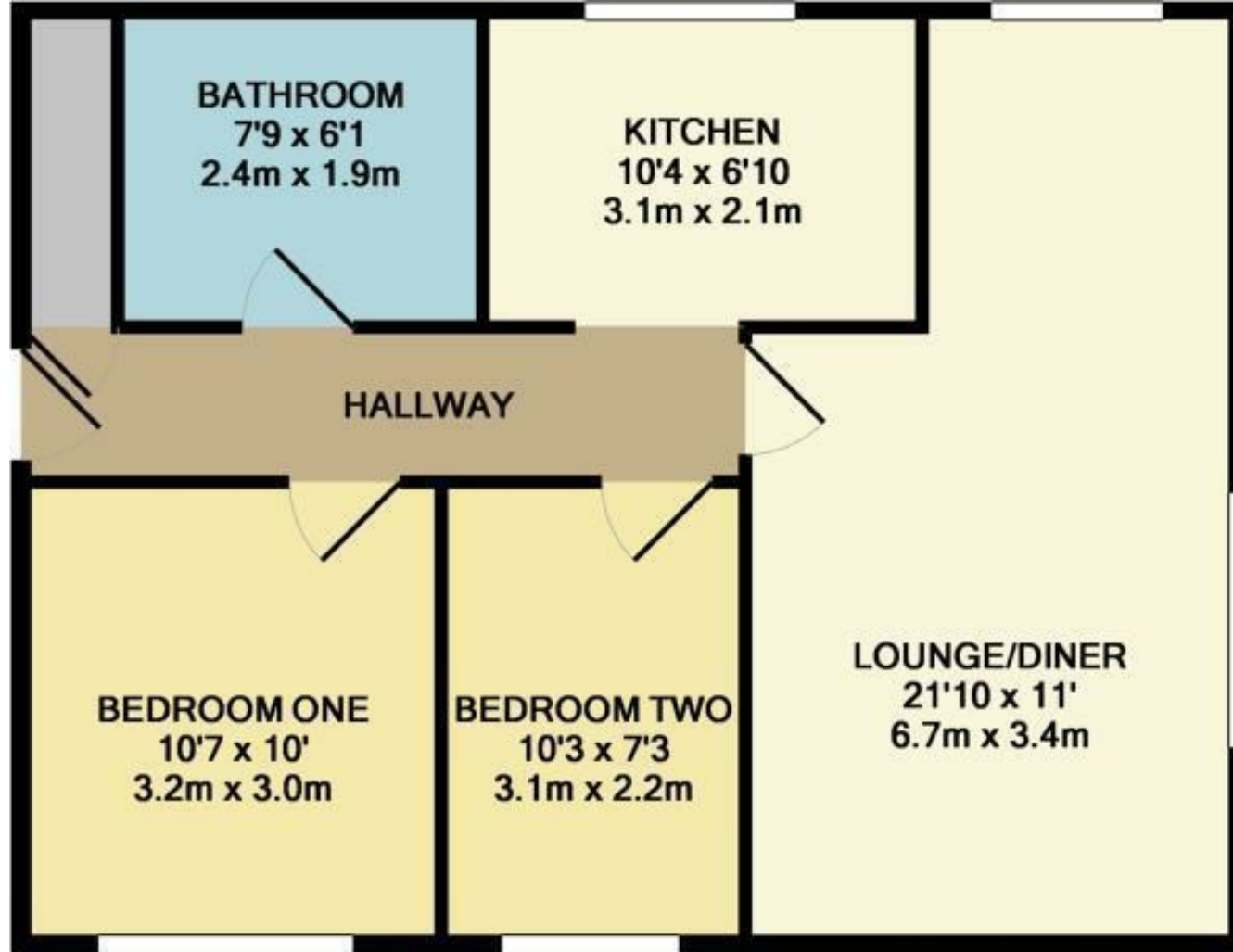



Lampits, Hoddesdon, EN11 8EH

** B2L INVESTORS ONLY - PORTFOLIO ACQUISITION AVAILABLE ** Westwood Leber are pleased to offer this spacious and well presented two bedroom apartment benefiting from a garage en-bloc and a long lease. The property is conveniently located, only a short distance from the market town of Hoddesdon. The property is offered CHAIN FREE.



Whilst every attempt has been made to ensure the accuracy of the floor plan contained here, measurements of doors, windows, rooms and any other items are approximate and no responsibility is taken for any error, omission, or mis-statement. This plan is for illustrative purposes only and should be used as such by any prospective purchaser. The services, systems and appliances shown have not been tested and no guarantee as to their operability or efficiency can be given.
Made with Metropix ©2017

