

Esdaile Lane, Hoddesdon, EN11 8DS

Westwood Leber are delighted to bring to the market this deceptively spacious four double bedroom townhouse, located just a stone's throw from Hoddesdon town centre with its wide range of high street shops, restaurants, cafés, pubs, and excellent bus services. Offering over 1300 sq. ft. of accommodation across three floors and benefits from a driveway and an integral garage. To the rear, there is a generously sized garden, mainly laid to lawn, providing ample outdoor space. This property is offered chain-free and is ready to purchase without delay.



 WESTWOODLEBER

Ground Floor

Approx. 42.7 sq. metres (460.1 sq. feet)

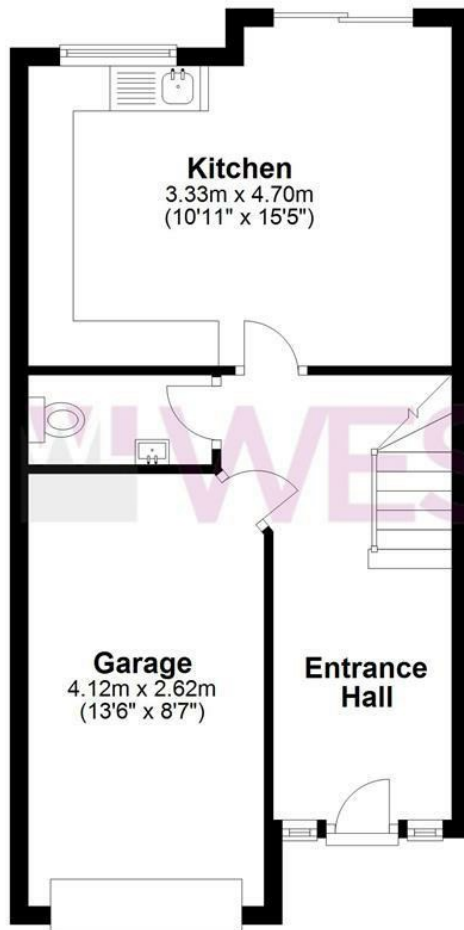

First Floor

Approx. 42.5 sq. metres (457.2 sq. feet)



Second Floor

Approx. 42.5 sq. metres (457.2 sq. feet)

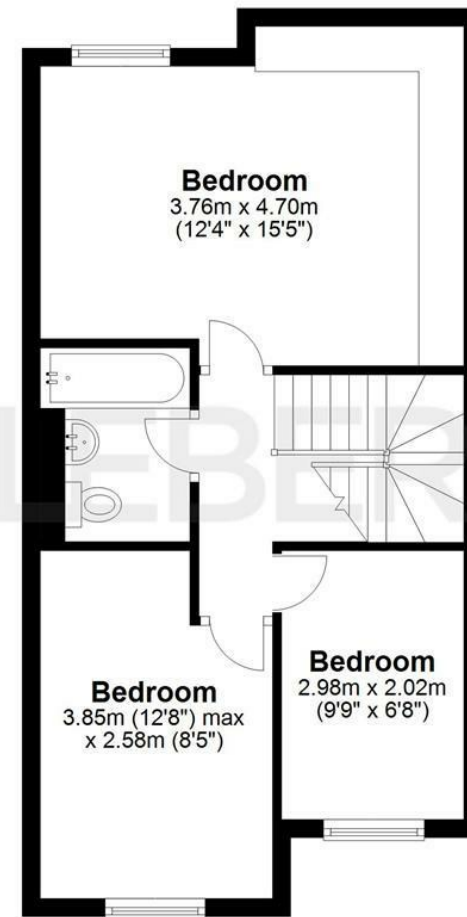

Total area: approx. 127.7 sq. metres (1374.6 sq. feet)

THE FLOORPLAN IS FOR ILLUSTRATIVE PURPOSES ONLY AND IS NOT TO SCALE. Measurements and features are approximate and may differ from the actual property. Verify all details independently; no liability is accepted for errors or omissions.

Property marketing provided by www.fotomarketing.co.uk







