



WESTWOODLEBER
LET US GUIDE YOU HOME

Stewart Place, Station Road, Ware, SG12 9UN
Offers in excess of £270,000



Stewart Place, Station Road, Ware, SG12 9UN

**** PERFECT FOR FIRST TIME BUYERS OR AN INVESTMENT OPPORTUNITY **** Westwood Leber are delighted to bring to the market this immaculately presented two double bedroom top floor apartment on this popular development in Ware just a stones throw from Ware Railway Station offering fantastic links into London via Liverpool Street and Tottenham Hale. This property has been tastefully updated by the current owner include a new modern fitted kitchen, newly fitted three-piece bathroom suite, newly laid flooring throughout, smart heating system, and allocated and permit parking. An internal viewing is highly recommended!



WESTWOODLEBER

WESTWOODLEBER
LET US GUIDE YOU HOME

Ground Floor

Approx. 51.1 sq. metres (550.0 sq. feet)

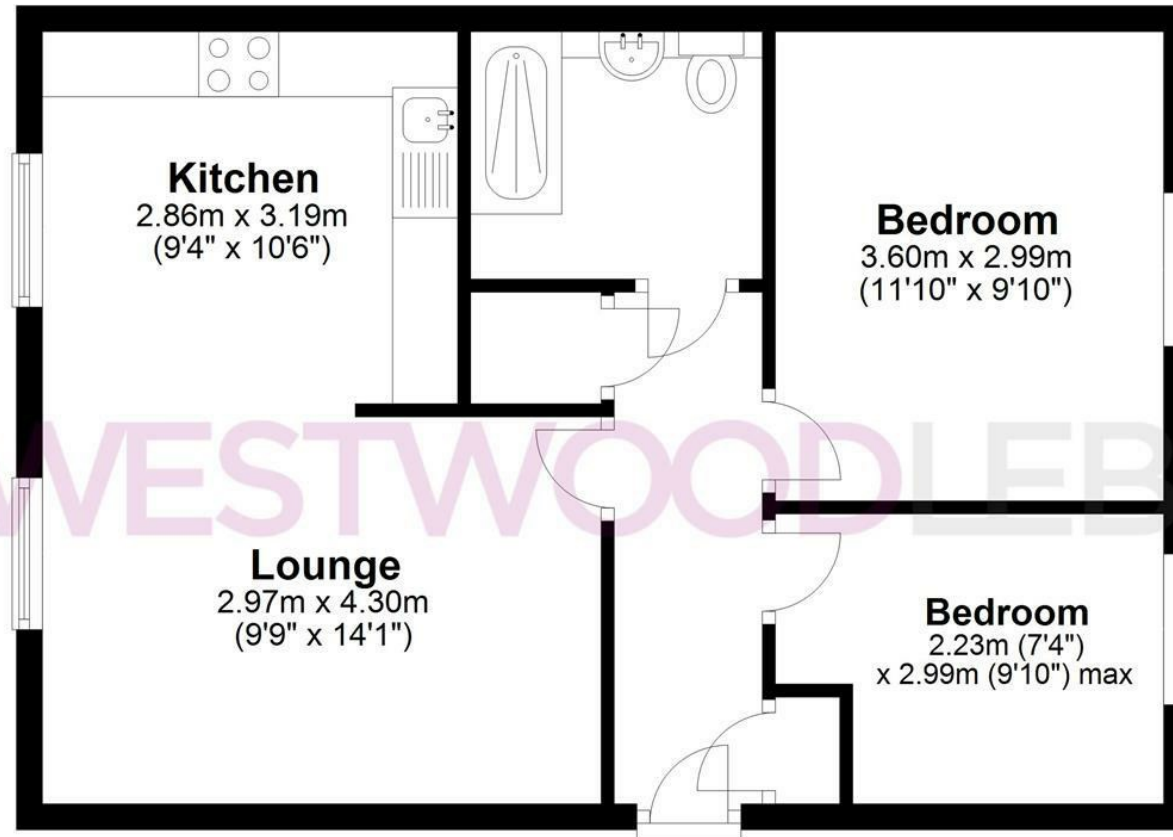

Total area: approx. 51.1 sq. metres (550.0 sq. feet)

FOR ILLUSTRATIVE PURPOSES ONLY. NOT TO SCALE. Whilst every attempt had been made to ensure the accuracy of the floor plan shown, all measurements, positioning, fixtures, features, fittings and any other data shown are an approximate interpretation for illustrative purposes only and are not to scale. No responsibility is taken for any error, omission, miss-statement or use of data shown. Property marketing provided by Westwood Leber.

Plan produced using PlanUp.





 WESTWOODLEBER

 WESTWOODLEBER
LET US GUIDE YOU HOME