



WESTWOODLEBER

**WESTWOODLEBER**  
LET US GUIDE YOU HOME

Western Road, Nazeing, Waltham Abbey, EN9 2QQ  
Offers in excess of £400,000



## Western Road, Nazeing, Waltham Abbey, EN9 2QQ

Westwood Leber are delighted to bring to the market this excellent three bedroom semi detached house located on a popular residential road in Nazeing. This lovely family home comes with a fabulous, substantially sized rear garden and plenty of scope to extend and improve stpp.

The accommodation comprises: two reception rooms, separate kitchen, three first floor bedrooms, family bathroom, driveway and garage. An early viewing is highly recommended.



**W** WESTWOODLEBER

## Ground Floor

Approx. 38.9 sq. metres (418.9 sq. feet)

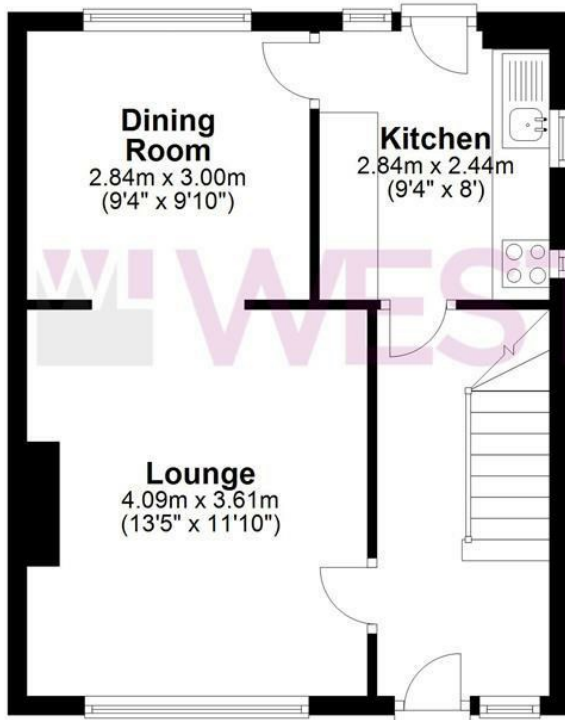

## First Floor

Approx. 38.9 sq. metres (418.9 sq. feet)

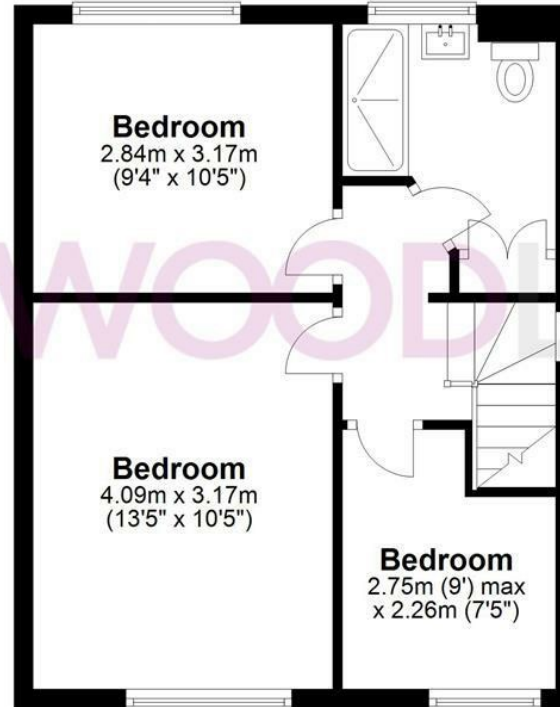

## Garage

Approx. 11.7 sq. metres (126.5 sq. feet)

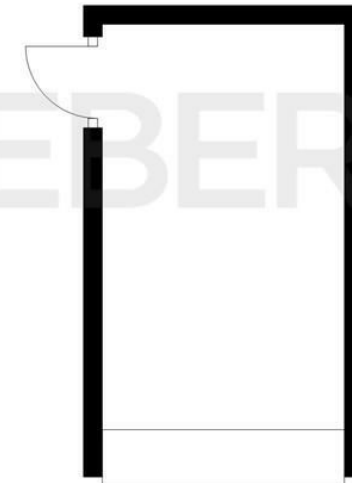

Total area: approx. 89.6 sq. metres (964.3 sq. feet)

FOR ILLUSTRATIVE PURPOSES ONLY. NOT TO SCALE. Whilst every attempt had been made to ensure the accuracy of the floor plan shown, all measurements, positioning, fixtures, features, fittings and any other data shown are an approximate interpretation for illustrative purposes only and are not to scale. No responsibility is taken for any error, omission, miss-statement or use of data shown.

[Property marketing provided by www.fotomarketing.co.uk](http://www.fotomarketing.co.uk)











