



WESTWOODLEBER
LET US GUIDE YOU HOME

Old Highway, Hoddesdon, EN11 0LX
£475,000



Old Highway, Hoddesdon, EN11 0LX

Westwood Leber are delighted to bring to the market this truly stunning four-bedroom period property within walking distance of Rye House Rail Station and Hoddesdon town centre. This exceptional home has is set over three floors and has been extended by the current owners boasting a wealth of character. This fantastic home offers deceptively spacious accommodation throughout and comprises of a large kitchen, first floor bathroom suite, master bedroom with en-suite and dressing room and rear garden. An early viewing is highly recommended!



W WESTWOODLEBER

W WESTWOODLEBER
LET US GUIDE YOU HOME

Ground Floor
Approx. 60.3 sq. metres (648.6 sq. feet)

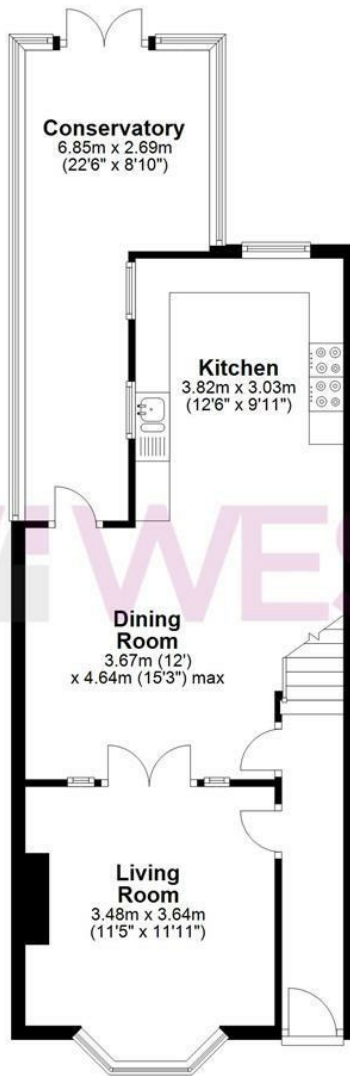

First Floor
Approx. 46.2 sq. metres (497.5 sq. feet)

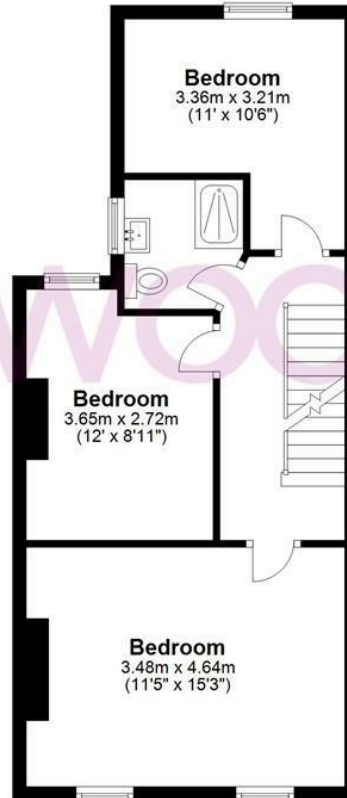

Second Floor
Approx. 38.9 sq. metres (418.3 sq. feet)



Total area: approx. 145.3 sq. metres (1564.4 sq. feet)

THE FLOORPLAN IS FOR ILLUSTRATIVE PURPOSES ONLY AND IS NOT TO SCALE. Measurements and features are approximate and may differ from the actual property. Verify all details independently; no liability is accepted for errors or omissions.

Property marketing provided by www.fotomarketing.co.uk
Plan produced using PlanUp.



WESTWOODLEBER



WESTWOODLEBER



WESTWOODLEBER



WESTWOODLEBER







