



**WESTWOODLEBER**  
LET US GUIDE YOU HOME

High Street, Roydon, Harlow, CM19 5EA  
£425,000



## High Street, Roydon, Harlow, CM19 5EA

Westwood Leber are delighted to bring to the market this immaculately presented three bedroom end terrace townhouse. The property offers deceptively spacious accommodation set over three floors comprising a ground floor w/c, modern kitchen, en-suite to master bedroom and off street parking. Roydon Mews is a cluster of recently built homes located perfectly in the heart of Roydon and within short walk to Roydon Rail Station.



**W<sup>L</sup> WESTWOODLEBER**

**W<sup>L</sup> WESTWOODLEBER**  
LET US GUIDE YOU HOME

GROUND FLOOR

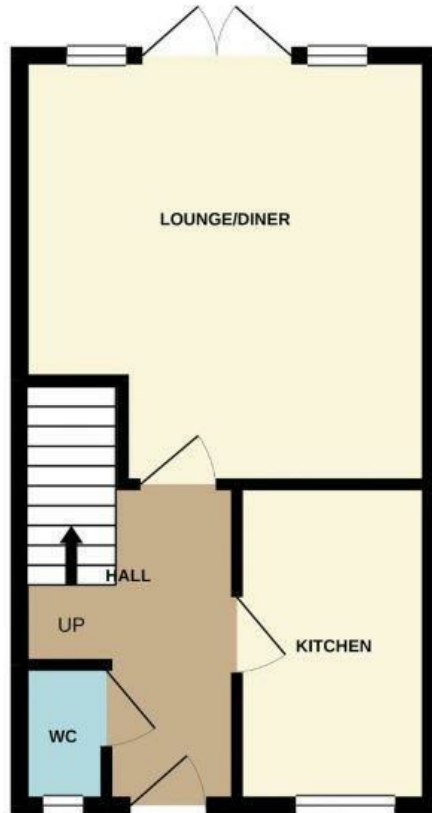

1ST FLOOR

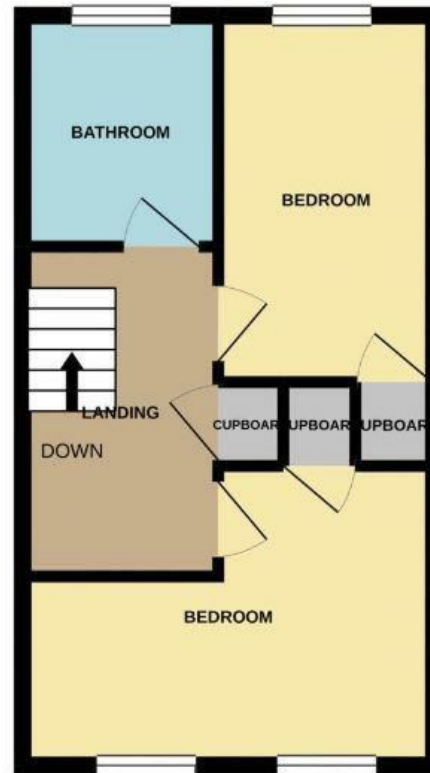

2ND FLOOR



Whilst every attempt has been made to ensure the accuracy of the floorplan contained here, measurements of doors, windows, rooms and any other items are approximate and no responsibility is taken for any error, omission or mis-statement. This plan is for illustrative purposes only and should be used as such by any prospective purchaser. The services, systems and appliances shown have not been tested and no guarantee as to their operability or efficiency can be given.  
Made with Metropix ©2020









**W** WESTWOODLEBER

**W** WESTWOODLEBER  
LET US GUIDE YOU HOME