



WESTWOODLEBER

**WESTWOODLEBER**  
LET US GUIDE YOU HOME

Western Road, Nazeing, Waltham Abbey, EN9 2QH  
£450,000



## Western Road, Nazeing, Waltham Abbey, EN9 2QH

Westwood Leber are delighted to bring to the market this exceptional three bedroom semi-detached family home located in the heart of Nazeing. This property offers excellent living accommodation throughout including three good size bedrooms, first floor bathroom, large free-flowing lounge/ diner, and a separate refitted kitchen. Further benefits include a detached garage, a large front driveway and patio doors opening out onto a fantastic rear garden. Internal viewing is highly recommended!



**WESTWOODLEBER**

**WESTWOODLEBER**  
LET US GUIDE YOU HOME

## Ground Floor

Approx. 40.2 sq. metres (433.2 sq. feet)

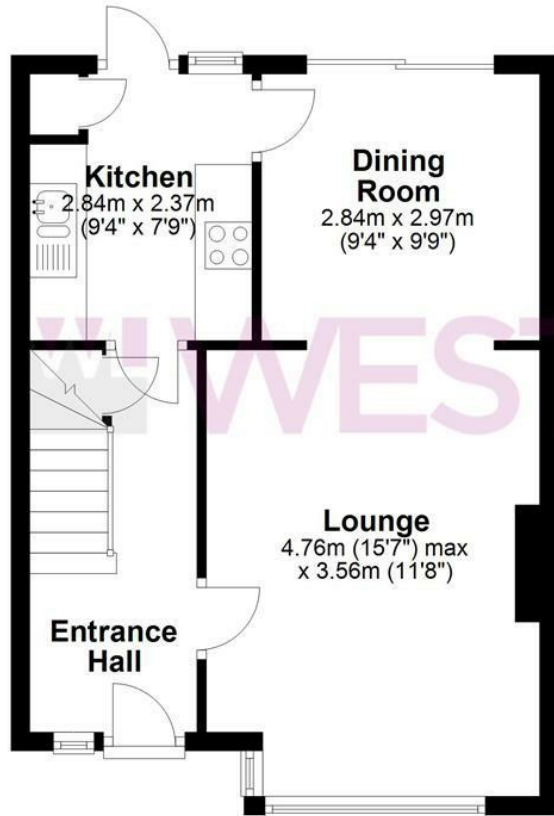

## First Floor

Approx. 38.7 sq. metres (417.0 sq. feet)

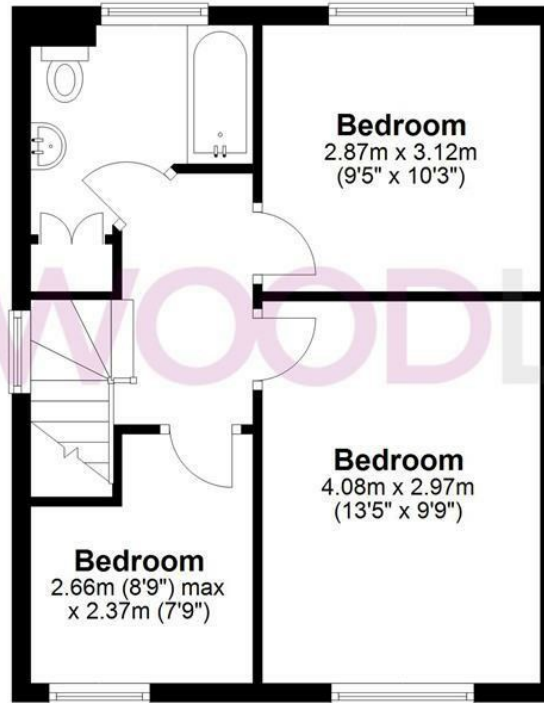

## Garage

Approx. 13.5 sq. metres (145.7 sq. feet)

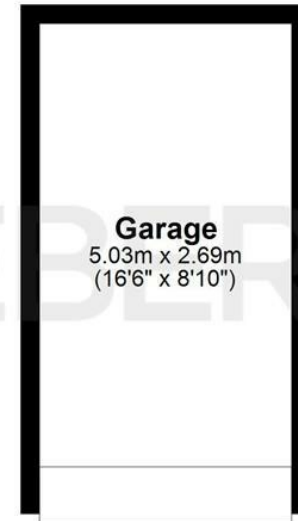

Total area: approx. 92.5 sq. metres (995.9 sq. feet)

FOR ILLUSTRATIVE PURPOSES ONLY. NOT TO SCALE. Whilst every attempt had been made to ensure the accuracy of the floor plan shown, all measurements, positioning, fixtures, features, fittings and any other data shown are an approximate interpretation for illustrative purposes only and are not to scale. No responsibility is taken for any error, omission, miss-statement or use of data shown.

[Property marketing provided by www.fotomarketing.co.uk](http://www.fotomarketing.co.uk)













**WESTWOODLEBER**

**WESTWOODLEBER**  
LET US GUIDE YOU HOME