



WILWESTWOODLEBER

**WILWESTWOODLEBER**  
LET US GUIDE YOU HOME

Fairfield Road, Huddesdon, EN11 9HF  
£535,000





## Fairfield Road, Hoddesdon, EN11 9HF

Westwood Leber are delighted to bring to the market this deceptively spacious three/four bedroom semi-detached bungalow with a larger than average loft room. This property offers flexible living accommodation throughout including modern fitted open plan kitchen/ diner, separate lounge, further reception room, two downstairs bedrooms and a downstairs three-piece bathroom suite.

To the first floor there is a master bedroom boasting 20ft x 11ft of space with a fitted dressing room and en-suite shower room. Further benefits include off-street parking for multiple cars and electric charger point, well landscaped rear garden and a garage with rear access. An internal viewing is highly recommended!





**WESTWOODLEBER**

**WESTWOODLEBER**  
LET US GUIDE YOU HOME

## Ground Floor

Approx. 77.2 sq. metres (830.6 sq. feet)



## First Floor

Approx. 38.2 sq. metres (411.0 sq. feet)

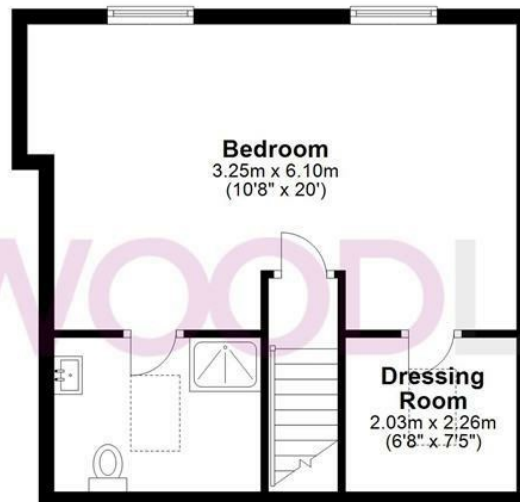

## Garage

Approx. 13.4 sq. metres (144.5 sq. feet)



Total area: approx. 128.8 sq. metres (1386.2 sq. feet)

FOR ILLUSTRATIVE PURPOSES ONLY. NOT TO SCALE. Whilst every attempt had been made to ensure the accuracy of the floor plan shown, all measurements, positioning, fixtures, features, fittings and any other data shown are an approximate interpretation for illustrative purposes only and are not to scale. No responsibility is taken for any error, omission, miss-statement or use of data shown.

Property marketing provided by [www.fotomarketing.co.uk](http://www.fotomarketing.co.uk)













WESTWOODLEBER



WESTWOODLEBER



WESTWOODLEBER



WESTWOODLEBER











