



WV WESTWOODLEBER

**WV WESTWOODLEBER**  
LET US GUIDE YOU HOME

Bulrush Way, Broxbourne, EN10 6GS  
£315,000





## Bulrush Way, Broxbourne, EN10 6GS

Westwood Leber are delighted to bring to the market this immaculately presented one bedroom ground floor apartment with its own 15ft x 20ft private garden, set on this exclusive and newly built development in the heart of Broxbourne, just a short walk from Broxbourne rail station servicing both Tottenham Hale and London Liverpool Street.

This fantastic apartment offers well thought-out living accommodation throughout, comprising of a contemporary open plan kitchen/lounge/dining room, one large double bedroom with double doors opening out onto a private rear garden and a separate three-piece bathroom suite. Further benefits include allocated parking with electric car charger, 8 years left on the NHBC guarantee, integrated appliances and gas central heating. Internal viewing is highly recommended!





**WV WESTWOODLEBER**

**WV WESTWOODLEBER**  
LET US GUIDE YOU HOME

## Apartment

Approx. 49.6 sq. metres (533.7 sq. feet)

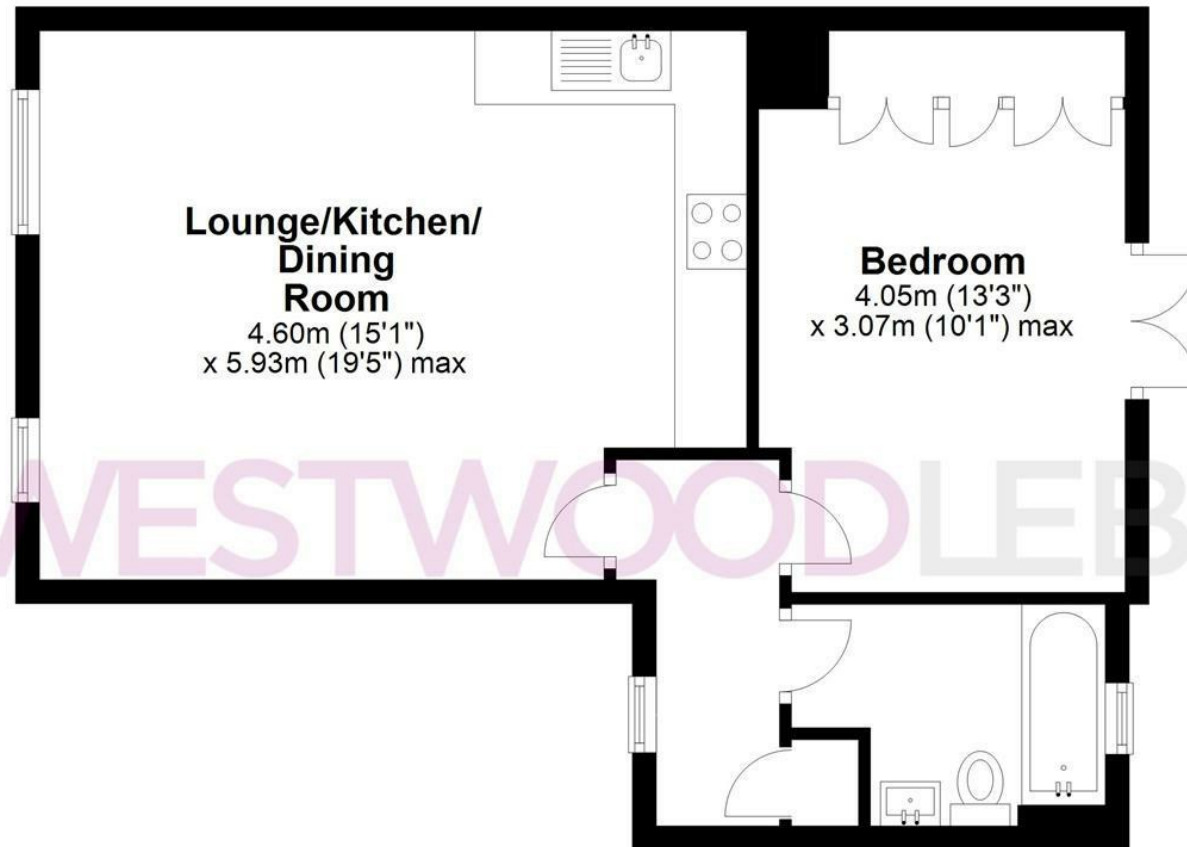

Total area: approx. 49.6 sq. metres (533.7 sq. feet)

FOR ILLUSTRATIVE PURPOSES ONLY. NOT TO SCALE. Whilst every attempt had been made to ensure the accuracy of the floor plan shown, all measurements, positioning, fixtures, features, fittings and any other data shown are an approximate interpretation for illustrative purposes only and are not to scale. No responsibility is taken for any error, omission, miss-statement or use of data shown.

Property marketing provided by [www.fotomarketing.co.uk](http://www.fotomarketing.co.uk)

















