



WESTWOODLEBER
LET US GUIDE YOU HOME

Heathgate, Hertford Heath, Hertford, SG13 7PL
£425,000



Heathgate, Hertford Heath, Hertford, SG13 7PL

Westwood Leber are delighted to bring to the market this beautifully presented three bedroom family home positioned perfectly within this popular residential cul-de-sac in Hertford Heath. The property has been tastefully updated throughout by the current owner with accommodation comprising a luxury open plan kitchen/living space, ground floor w/c, luxury first floor bathroom, well maintained rear garden and a garage.



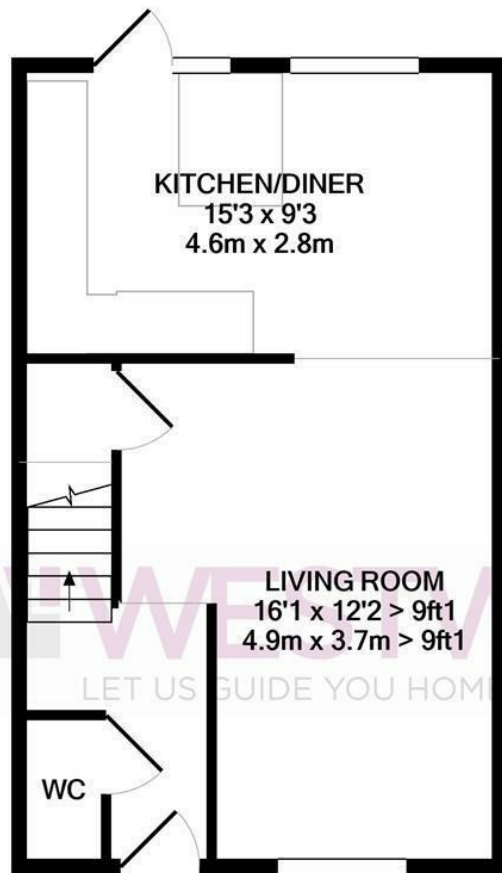

GROUND FLOOR
APPROX. FLOOR
AREA 386 SQ.FT.
(35.9 SQ.M.)

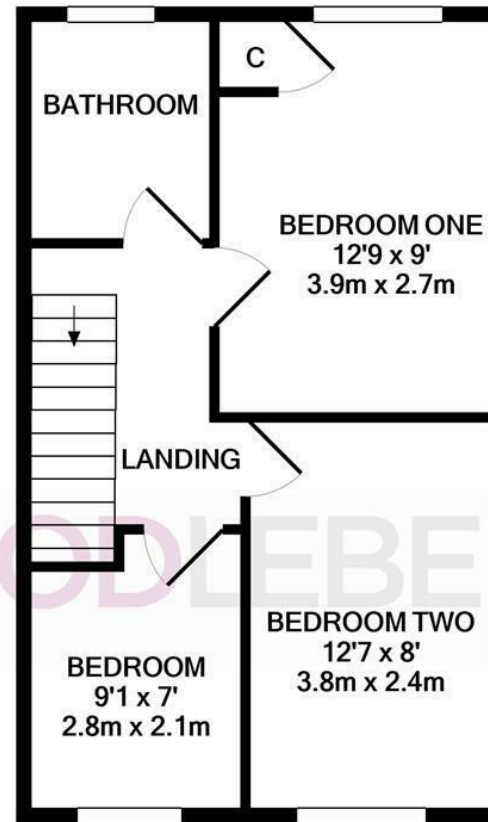

1ST FLOOR
APPROX. FLOOR
AREA 381 SQ.FT.
(35.4 SQ.M.)

TOTAL APPROX. FLOOR AREA 767 SQ.FT. (71.3 SQ.M.)

Whilst every attempt has been made to ensure the accuracy of the floor plan contained here, measurements of doors, windows, rooms and any other items are approximate and no responsibility is taken for any error, omission, or mis-statement. This plan is for illustrative purposes only and should be used as such by any prospective purchaser. The services, systems and appliances shown have not been tested and no guarantee as to their operability or efficiency can be given
Made with Metropix ©2020

