





Hargreaves Avenue, Cheshunt, Waltham Cross, EN7 5BD

****OPEN DAY ON SATURDAY 13th JULY**** Westwood Leber are delighted to bring to the market this immaculately presented three bedroom family home in this sought after residential road in West Cheshunt. This property has been tastefully updated by the current owners and boasts a wealth of space throughout comprising of a large modern fitted kitchen/diner, a well sized family lounge and a larger than average master bedroom. Further benefits include a well-landscaped rear garden, off-street parking for up to three cars and ample storage. An early viewing is highly recommended!



W WESTWOODLEBER

W WESTWOODLEBER
LET US GUIDE YOU HOME

Ground Floor

Approx. 37.6 sq. metres (404.5 sq. feet)

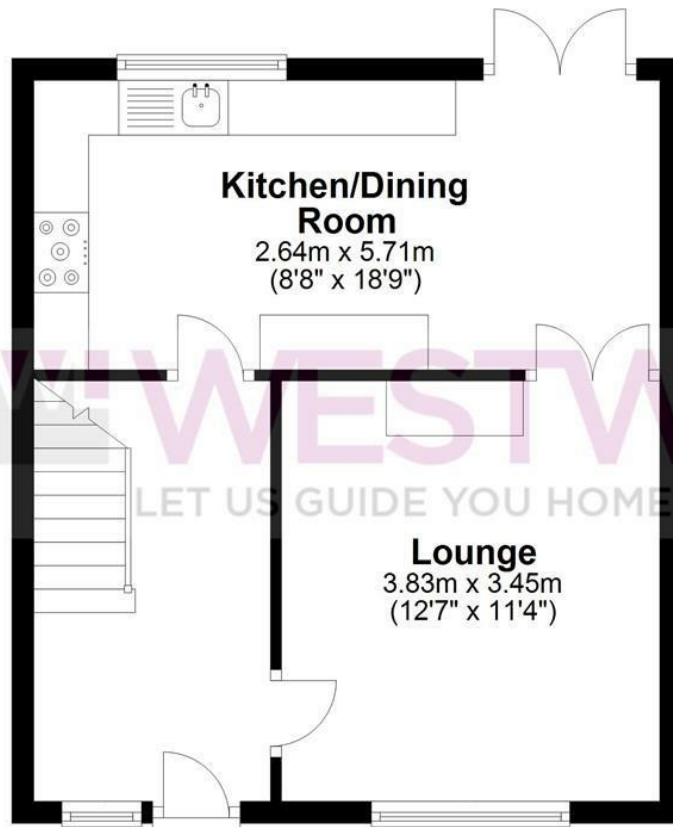

First Floor

Approx. 37.4 sq. metres (402.5 sq. feet)

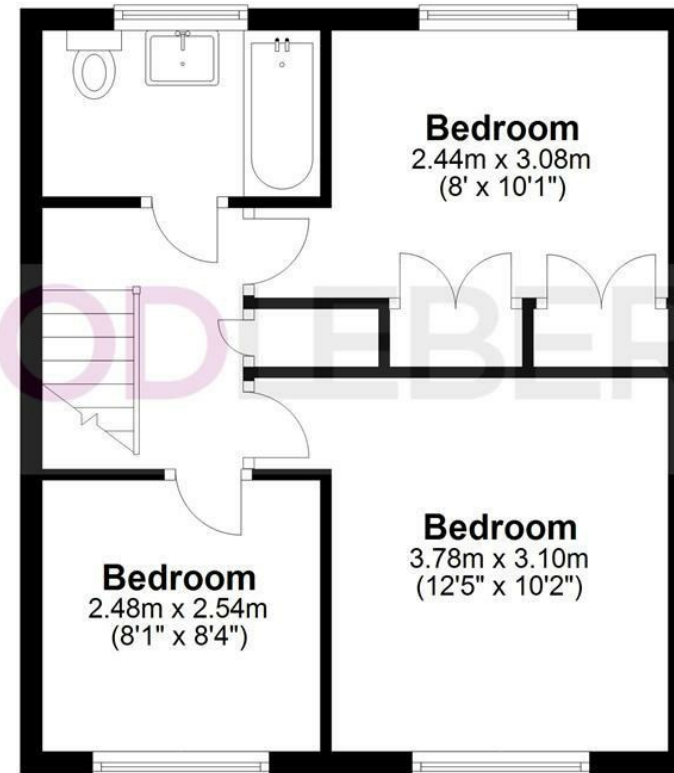

Total area: approx. 75.0 sq. metres (807.0 sq. feet)

FOR ILLUSTRATIVE PURPOSES ONLY. NOT TO SCALE. Whilst every attempt had been made to ensure the accuracy of the floor plan shown, all measurements, positioning, fixtures, features, fittings and any other data shown are an approximate interpretation for illustrative purposes only and are not to scale. No responsibility is taken for any error, omission, miss-statement or use of data shown. Property marketing provided by Westwood Leber.

Plan produced using PlanUp.







