



WESTWOODLEBER

**WESTWOODLEBER**  
LET US GUIDE YOU HOME

Old Highway, Hoddesdon, EN11 0LT  
£250,000



## Old Highway, Hoddesdon, EN11 0LT

Westwood Leber are delighted to bring to the market this rarely available one-bedroom ground-floor maisonette just a short walk away from Rye House Rail Station. The property has been updated by the current owners and benefits from a modern kitchen and bathroom, a basement double bedroom, a large lounge, and ample storage. An internal viewing is highly recommended!



**WESTWOODLEBER**

**Ground Floor**  
Approx. 47.8 sq. metres (514.8 sq. feet)

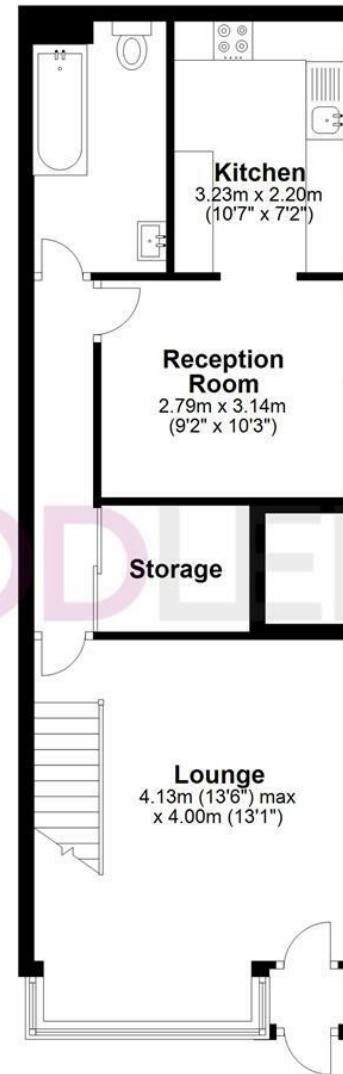

WESTWOODLEBER

**Basement**  
Approx. 11.9 sq. metres (127.9 sq. feet)

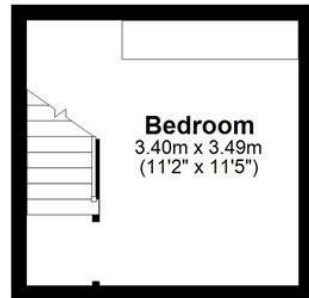

Total area: approx. 59.7 sq. metres (642.6 sq. feet)

FOR ILLUSTRATIVE PURPOSES ONLY. NOT TO SCALE. Whilst every attempt had been made to ensure the accuracy of the floor plan shown, all measurements, positioning, fixtures, features, fittings and any other data shown are an approximate interpretation for illustrative purposes only and are not to scale. No responsibility is taken for any error, omission, miss-statement or use of data shown. Property marketing provided by Foto Ltd.  
Plan produced using PlanUp.

