



WESTWOODLEBER
LET US GUIDE YOU HOME

Ramsay Close, Broxbourne, EN10 7DR
Offers over £700,000



Ramsay Close, Broxbourne, EN10 7DR

Westwood Leber are delighted to bring to the market this immaculately presented four bedroom end of terrace family home in this sought after residential close in Broxbourne. This property has been tastefully updated and extended by the current owners and boasts a wealth of desired features such as a large open plan, modern fitted kitchen with a large island and bi-folding doors out to a well landscaped rear garden. Further benefits include three double bedrooms, a drive for multiple cars, a downstairs w/c and ample storage. An internal viewing is highly recommended!



WESTWOODLEBER

WESTWOODLEBER
LET US GUIDE YOU HOME

Ground Floor

Approx. 57.6 sq. metres (620.0 sq. feet)



First Floor

Approx. 40.9 sq. metres (439.7 sq. feet)



Second Floor

Approx. 32.3 sq. metres (347.4 sq. feet)

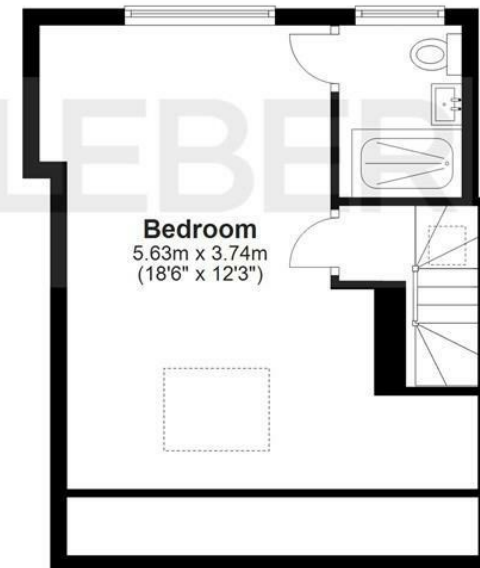

Total area: approx. 130.7 sq. metres (1407.1 sq. feet)

FOR ILLUSTRATIVE PURPOSES ONLY. NOT TO SCALE. Whilst every attempt had been made to ensure the accuracy of the floor plan shown, all measurements, positioning, fixtures, features, fittings and any other data shown are an approximate interpretation for illustrative purposes only and are not to scale. No responsibility is taken for any error, omission, miss-statement or use of data shown. Property marketing provided by Westwood Leber. Plan produced using PlanUp.







