



WESTWOODLEBER

WESTWOODLEBER
LET US GUIDE YOU HOME

Lampits, Hoddesdon, EN11 8DY
£540,000



Lampits, Hoddesdon, EN11 8DY

**** CHAIN FREE **** Westwood Leber are delighted to bring to the market this completely refurbished and deceptively spacious three double-bedroom family home positioned perfectly on a popular residential road in Hoddesdon. This property has been tastefully updated by the current owners and benefits from a wealth of desired features such as a modern fitted kitchen suite with an island, downstairs w/c, and a low-maintenance rear garden. Further benefits include a modern four-piece bathroom suite, bi-folding doors, 2 reception rooms, and a drive to the front for multiple cars. An internal viewing is highly recommended!



WESTWOODLEBER

WESTWOODLEBER
LET US GUIDE YOU HOME

Ground Floor

Approx. 68.5 sq. metres (737.9 sq. feet)

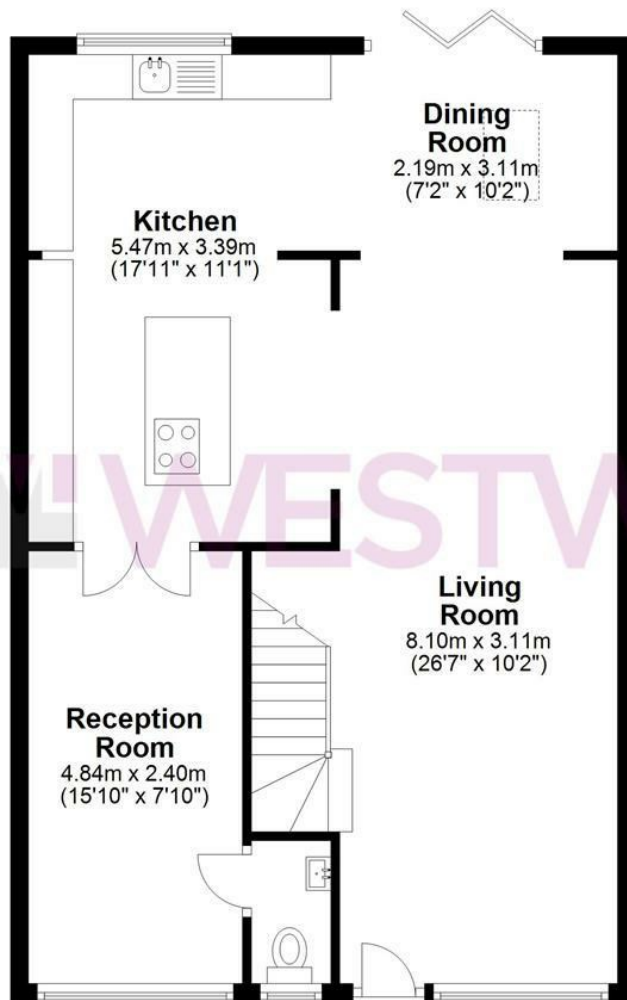

First Floor

Approx. 42.9 sq. metres (461.3 sq. feet)



Total area: approx. 111.4 sq. metres (1199.2 sq. feet)

FOR ILLUSTRATIVE PURPOSES ONLY. NOT TO SCALE. Whilst every attempt had been made to ensure the accuracy of the floor plan shown, all measurements, positioning, fixtures, features, fittings and any other data shown are an approximate interpretation for illustrative purposes only and are not to scale. No responsibility is taken for any error, omission, miss-statement or use of data shown. Property marketing provided by Westwood Leber.

Plan produced using PlanUp.





