



18 Aylwards Way, Stockbridge, SO20 8HB
£1,300

PROPERTY DESCRIPTION BY Ella Flint

Charming Two-Bedroom Bungalow in Nether Wallop – No Onward Chain

Located in a peaceful close just off Five Bells Lane, this two-bedroom semi-detached bungalow offers a wonderful opportunity to create a lovely home in the heart of the sought-after village of Nether Wallop. Positioned within easy walking distance of the village playing fields, park, and tennis court, the property enjoys a quiet yet convenient setting ideal for those seeking a relaxed rural lifestyle. The accommodation includes a welcoming sitting room with French doors that open onto a patio and the enclosed rear garden, creating a pleasant indoor-outdoor connection. At the front of the property, the kitchen features a side door and a useful built-in larder for additional storage. There are two comfortable bedrooms, and while the bungalow would benefit from some updating, it holds excellent potential for modernisation and personalisation. To the front, there is off-road parking and an open-plan garden, while the rear garden is enclosed and offers a private space to relax or entertain. With no onward chain, this property is an appealing option for downsizers, first-time buyers or investors looking to add value in a desirable Hampshire village.

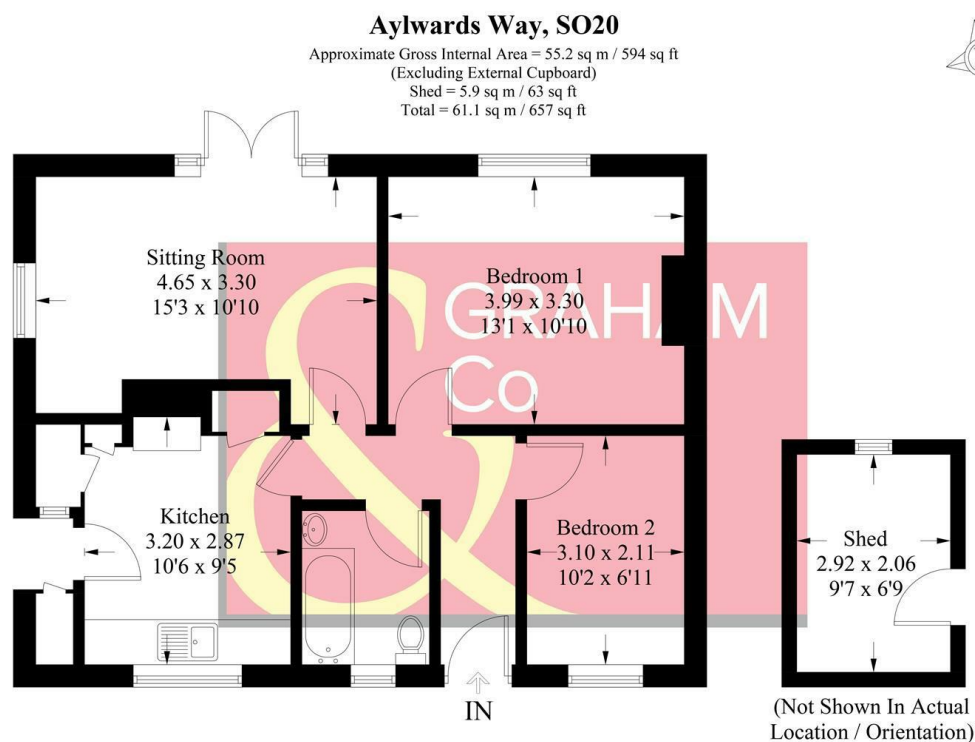

PRODUCED FOR GRAHAM AND CO
Whilst every attempt has been made to ensure the accuracy of the floorplan, measurements of doors, windows and rooms are approximate. These plans are for representation purposes only as defined by RICS Code of Measuring Practice and used as such by any prospective purchaser. © Emzo Marketing (ID1211943)

DIRECTIONS

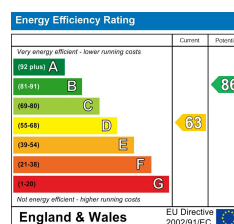

Tax Band: B



OPEN 7 DAYS

If you are considering selling your home
please contact us today for your free
no obligation valuation

01264 356500

IMPORTANT: we would like to inform prospective purchasers that these sales particulars have been prepared as a general guide only. A detailed survey has not been carried out, nor the services, appliances and fittings tested. Room sizes should not be relied upon for furnishing purposes and are approximate. If floor plans are included, they are for guidance only and illustration purposes only and may not be to scale. If there are any important matters likely to affect your decision to buy, please contact us before viewing the property.