



flat 6 Suffolk Road, Andover, SP10 2GY
£875 Per Month

PROPERTY DESCRIPTION BY *Tanya Owens*

Graham and Co are delighted to present this two bedroom property located a stones throw away from town. The property comprises an entrance hall, two bedrooms with a master en-suite, an open plan living space with a fitted kitchen with doors leading to a balcony. Outside the property has the added benefit of a garage. The building comprises a lift.

Unfurnished,
Available ASAP,
No pets.

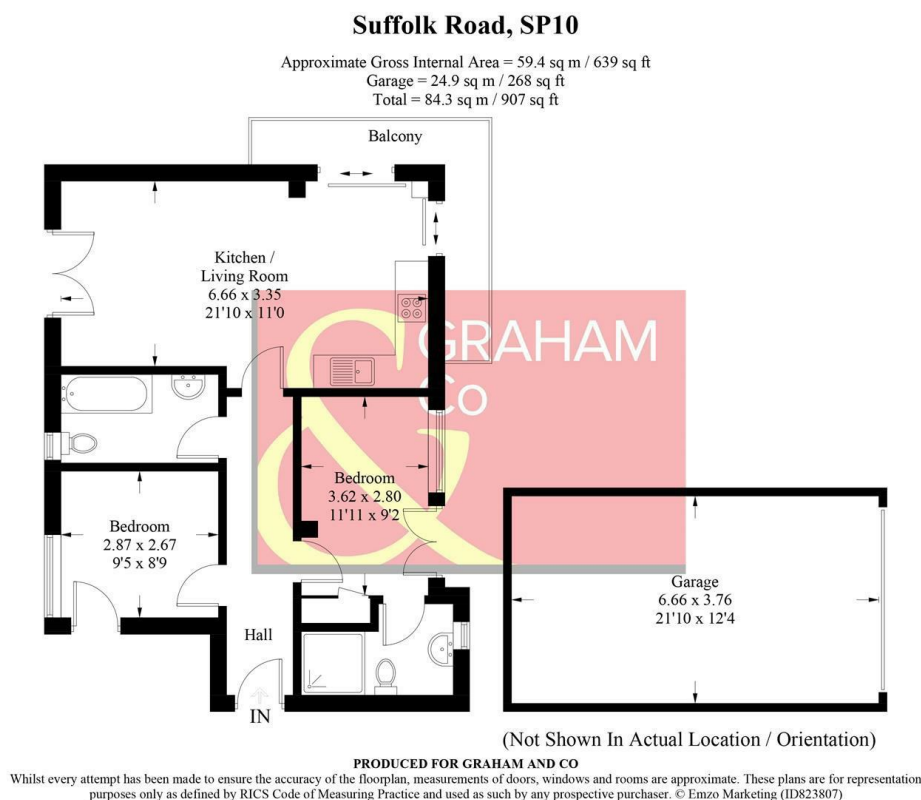

DIRECTIONS

From our office in London Street, proceed to the roundabout and take the third exit. At the following roundabout follow the road round in the left hand lane. Take the second turning into The Broadway and then immediately left into Suffolk Road.

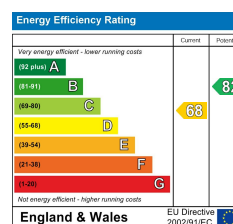

Tax Band: C



OPEN 7 DAYS

If you are considering selling your home
please contact us today for your free
no obligation valuation

01264 356500

IMPORTANT! we would like to inform prospective purchasers that these sales particulars have been prepared as a general guide only. A detailed survey has not been carried out, nor the services, appliances and fittings tested. Room sizes should not be relied upon for furnishing purposes and are approximate. If floor plans are included, they are for guidance only and illustration purposes only and may not be to scale. If there are any important matters likely to affect your decision to buy, please contact us before viewing the property.