

**GROUND FLOOR**

<b>M6 - 390 sq ft</b> VACANT
<b>M4 + M5 - 234 sq ft</b>

<b>M11 - 1092 sq ft</b>  Diner
--------------------------------------

<b>LIFT</b>
-------------

<b>M3 - 244 sq ft</b>  Pearl of the Orient
<b>M2+ M12 400 sq ft</b>  Soccer souvenirs and memorabilia

<b>G2 - 120 sq ft</b> Gold&silver jewellery		<b>G1 - 120 sq ft</b> CANVASS
<b>Pitch 1 - 100 sq ft</b> Shoes&bags		

<b>2-9 - 715 sq ft</b> RAGE Clothing	
<b>5+6 - 178 sq ft</b> L.B Nailbar Limited	<b>7+8 - 202 sq ft</b> Baby clothing&accessories
<b>1 - 462 sq ft</b> VACANT	<b>3 - 462 sq ft</b> L.B Nailbar Limited

<b>10 - 248 sq ft</b> Alpha Books	<b>15 - 80 sq ft</b> Retro Style furniture
<b>13 - 168 sq ft</b> TOYS	
<b>M1- 123 sq ft</b> NORION LUXURY	

**MEZZAZINE FLOOR**

<b>Mezz 8+Mezz 9 - 964 sq ft</b>  Aptus	<b>Mezz 7 - 474 sq ft</b>  BID	<b>Mezz 6 - 201 sq ft</b>  BID	<b>Mezz 5 - 201 sq ft</b>  BID	



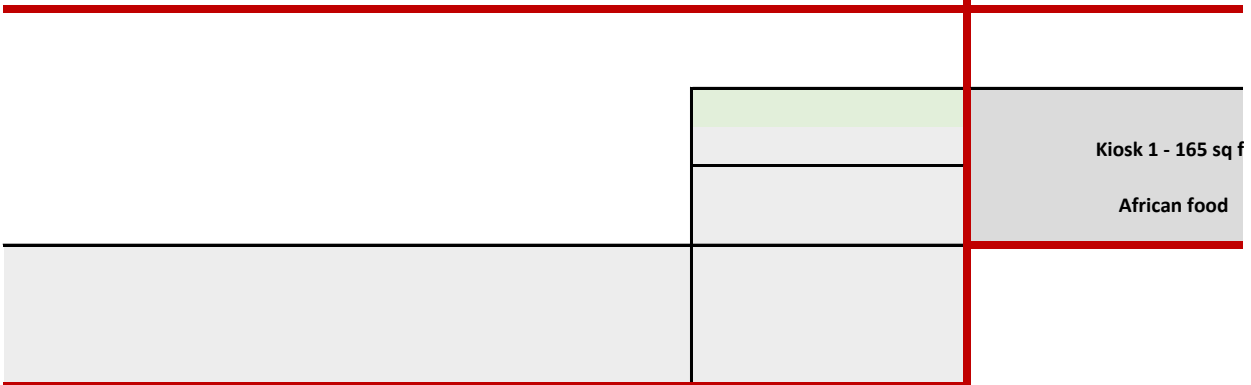
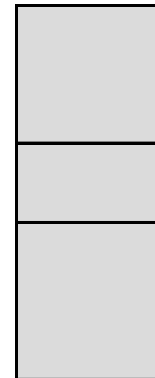
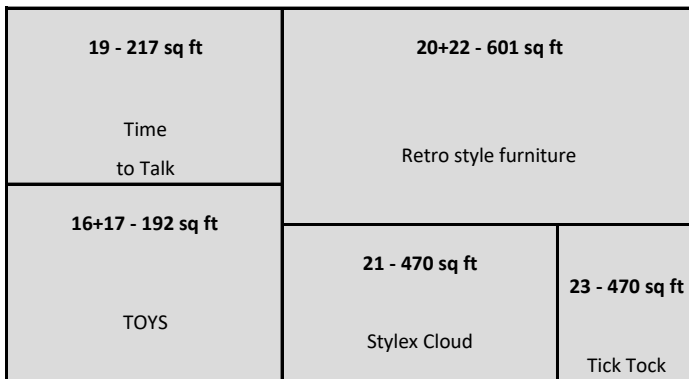
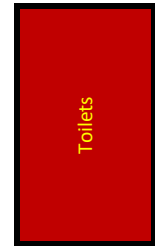
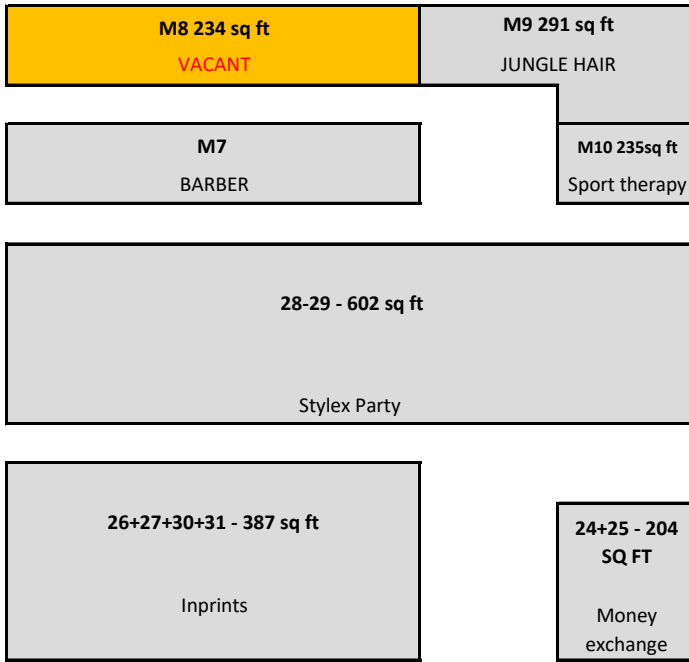



**FIRST FLOOR**

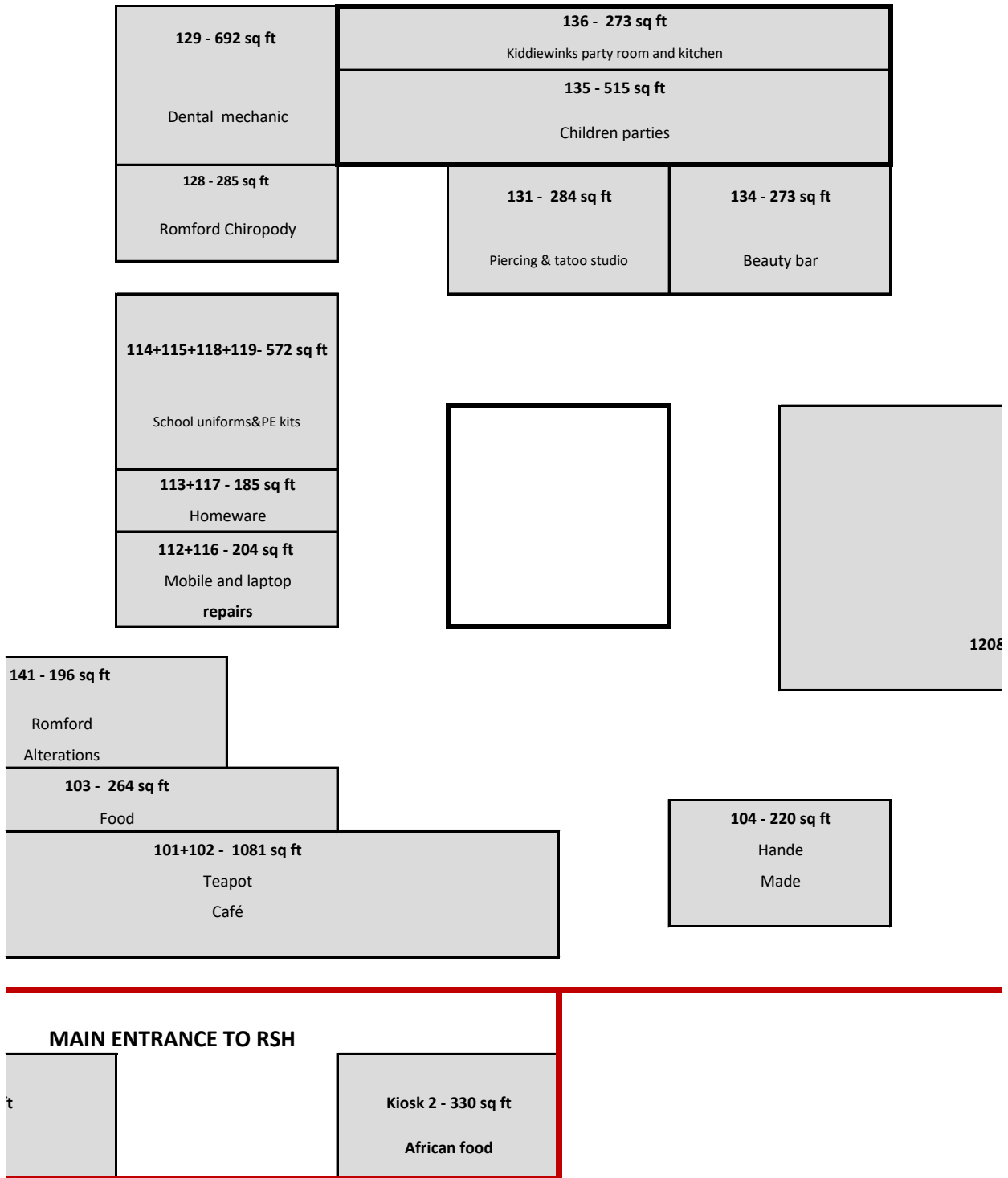

**Occupied Units**

<b>Unit No</b>	<b>Sq ft</b>
M7-10	1900
M2+M12	400
3+7+8	640
26+27+30+	387
131	284
104	220
10+11+12	248
M6	390
120+121+12	
2+126+123+	
124+125+12	
7+134+136+	
137+138+13	
9+140	3046
103	264
128	285
M4 & M5	234
M11	1092
101+102	1081
141	196
28-29, G1+	842
5+6	202
23	470
Kiosk 1+Kic	495
110-111	445
132	273
M3	244
135	515
129+130	692
20 & 22	601
113+114+11	
5+117+118+	
119	572
18+19	217
2+9	715
1	462
112 & 116	204
Mezz 8+Me	964
13+14	168
Mezz 6	201
Mezz 7	474
M1+16+17	315
105-109	1216
21	470
	<b><u>21424</u></b>

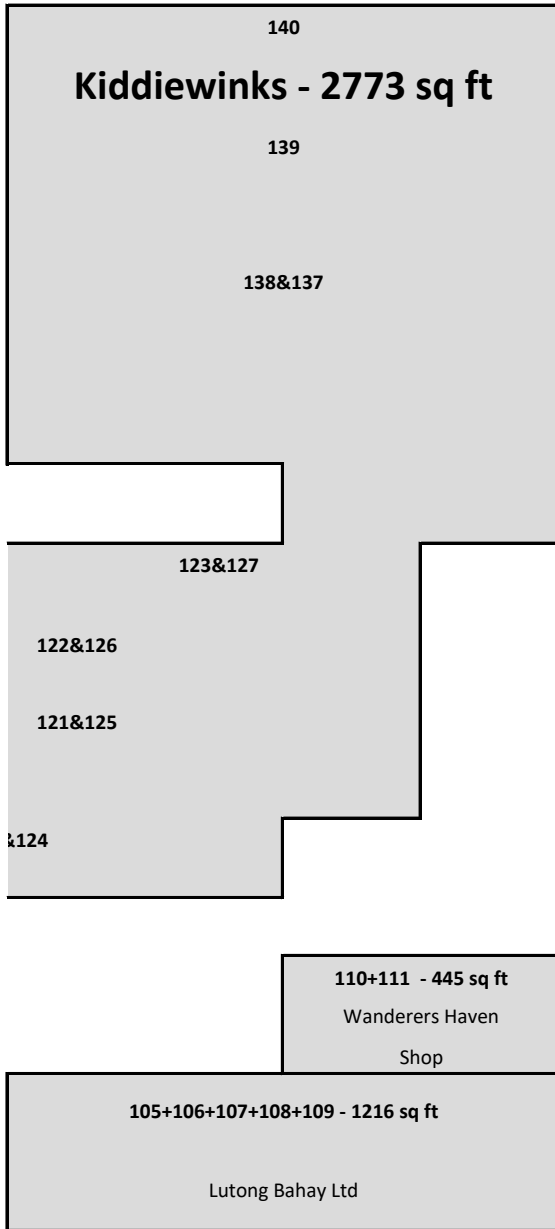

**Vacant Units**

<b>Unit No</b>	<b>Sq ft</b>
1	201
M6	624
M8	234
	<b>585</b>