



Valentine Cottage

BUCKINGHAMSHIRE • GUIDE PRICE £4,750 PER MONTH

A newly constructed, four-bedroom farmhouse perfectly connected with incredible transport links to London

- Large private garden with stunning countryside walks
- Four double bedrooms with plenty of reception space
- Moments from Amersham with easy transport links into London (Met & Chiltern Line)
- Built 3 years ago

DESCRIPTION

This property boasts an impressive amount of space, featuring a spacious open-plan dining kitchen and family room, a utility area, and a separate formal reception room. On the first floor, you'll find three double bedrooms, including one with an ensuite, along with a generously sized family bathroom.

Spanning three floors, the principal bedroom occupies the entire top floor and includes a luxurious ensuite bathroom. Designed with meticulous attention to detail, the house features high-quality fittings that blend modernity with the quaint appeal of a traditional farm cottage.

Surrounded by picturesque open fields, the location offers a peaceful retreat conveniently situated between Amersham and Chalfont St. Giles.

Externally, the property includes a shared driveway, a triple carport, and allocated parking for 2-3 vehicles.

••Disclaimer: Please note that the photos displayed are of the neighbouring property, which shares the same specifications and similar layout as this listing. The floorplan is of the property being listed.

TERMS

Price: Guide Price £4,750 per month

Local Authority: Buckinghamshire

Council Tax: Chiltern

Energy Rating: 85.00









Valentine Cottage, HP8

Approximate gross internal area

165.3 sq m / 1779 sq ft

(Including Eaves Storage)

Eaves Storage : 6.79 sq m / 73 sq ft

HardingGreen

Key :
CH - Ceiling Height

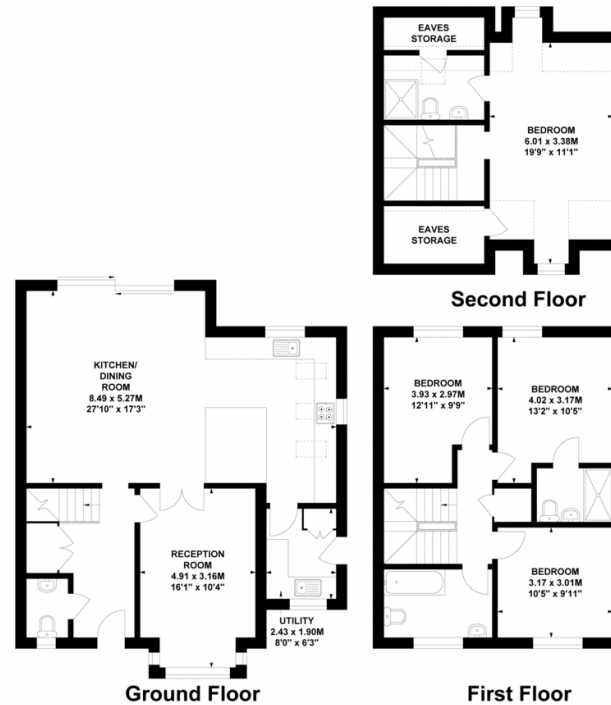

Not to scale, for guidance only and must not be relied upon as a statement of fact.
All measurements and areas are approximate only



Robbie Gittins

Partner

0203 879 0723

robbie.gittins@hardinggreen.com

Important Notice. We would like to inform prospective tenants that these lettings particulars have been prepared as a general guide only. A detailed survey has not been carried out, nor the services, appliances and fittings tested(remove). Room sizes should not be relied upon for furnishing purposes and are approximate. If floor plans are included, they are for guidance only and illustration purposes only and may not be to scale. If there are any important matters likely to affect your decision to rent, please contact us before viewing the property.



FIND OUT MORE