



Stableford

STABLEFORD • GUIDE PRICE £695,000

Beautifully restored 17th-century Grade II listed cottage with four bedrooms, original features, and landscaped gardens set in 0.5 acres. Includes garage/workshop, outbuildings, and countryside views. Quiet rural hamlet near Bridgnorth. No onward chain

DESCRIPTION

Clovers is a timeless example of English rural architecture — a Grade II listed, timber-framed cottage dating back to the 17th century, originally formed from three separate dwellings. Today, it has been seamlessly unified and sympathetically modernised to create a highly individual four-bedroom family home, where character and comfort coexist in perfect balance.

Set in the peaceful hamlet of Stableford, between the villages of Worfield and Badger, the property sits discreetly within approximately half an acre of meticulously landscaped gardens. Surrounded by open countryside and accessible via a shared private driveway, it offers both complete privacy and excellent connectivity, with Bridgnorth just 10 minutes away and Wolverhampton reachable in under 30 minutes.

Upon entering the home, visitors are welcomed by a quarry-tiled boot room, which serves as a practical entrance lobby and provides access to a ground-floor shower room, WC, storage cupboards and utility space. This thoughtful flow continues into the spacious kitchen-breakfast room, a highlight of the home with its bespoke oak cabinetry, granite worktops, Belfast sink, and integrated electric Aga. The space is flooded with natural light through dual aspect windows and features exposed beams and a generous walk-in pantry, making it the quintessential country kitchen.









Approximate Area = 1986 sq ft / 184.4 sq m
For identification only - Not to scale

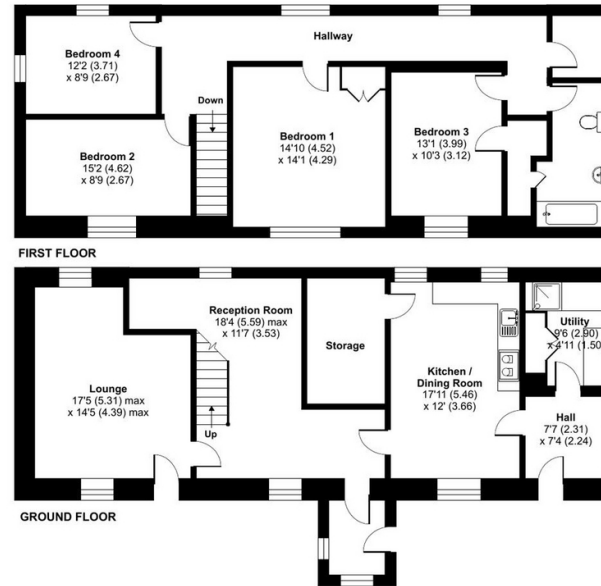

 Floor plan produced in accordance with RICS Property Measurement 2nd Edition, Incorporating International Property Measurement Standards (IPMS2 Residential). © richcom 2025. Produced for Halls. REF: 1285996



Thomas Dainty
Partner

0203 879 0742

thomas.dainty@hardinggreen.com

Important Notice. We would like to inform prospective purchasers that these sales particulars have been prepared as a general guide only. A detailed survey has not been carried out, nor the services, appliances and fittings tested. Room sizes should not be relied upon for furnishing purposes and are approximate. If floor plans are included, they are for guidance only and illustration purposes only and may not be to scale. If there are any important matters likely to affect your decision to buy, please contact us before viewing the property.



FIND OUT MORE